

FUJI JAPAN 富士日本

フジジャパンエレベーター株式会社 FUJI JAPAN ELEVATOR CO., LTD

Corporate Sales office Address: 3-7-6 Nukui, Nerima-ku,
Tokyo 176-0021, Japan

Headquarters Address: KANEKO JAPAN, Nihon Seimei
Shimbashi Bldg. 9F, No: 18-16, Shimbashi 1- Chome ,
Minato-Ku, Tokyo, Japan , 105-0004
Tell: 03 (3735) 7111, Fax: 03 (3735) 7781

Kamogawa Factory Address: 477 Bando, Kamogawa City,
(296-0016) Chiba Prefecture, Japan

TEL 04 (7093) 1511 FAX 04 (7093) 3366

Email: info@fujijapanco.com





Website: fujijapanco.com

Tell: +81-8031215817

FUJI JAPAN 富士日本



Elevator/Escalator エレベーター/エスカレーター

-  Passenger Elevator
-  Observation Elevator
-  Freight Elevator
-  Car Elevator
-  Villa Elevator
-  Escalator
-  Moving Walk

フジジャパンエレベーター株式会社
FUJI JAPAN ELEVATOR CO., LTD

COMPANY PROFILE

A wonderful style bears a kind of high-grade life. Though we can not define what life means. We shall choose high grade life.



FUJI JAPAN Elevator opens a window of the world by high tech. It is competitive in the global markets because of the high quality. FUJI JAPAN Elevator is always engaged in researching into, developing, manufacturing various building traffic and transport systems such as elevator, escalator, moving walk etc.

Through the centurial trials and hardships, FUJI JAPAN Elevator never changes its advanced technology. FUJI JAPAN Elevators safely operate in all kinds of high grade buildings in over 100 countries and regions. As time flies, it continues the rigorous and conscientious spirits of the Japan nation. FUJI JAPAN Elevator popular-fixes the most superb elevators and escalators all over the world and opens the gate of the artistic elevator palace. As a distinguished figure in the contemporary elevator industry, FUJI JAPAN Elevator witnesses orary elevator industry, the past and strides forwards a bright future.

It connects classical Japan art with the advanced modern technology. As a distinguished figure in the From now on, space talks to light, aesthetics combines with high tech. Grace integrates with comfortable operation. It wholeheartedly creates a smooth urban sight line. It starts a big vision of FUJI JAPAN. As a professional "one-stop" elevator and escalator solution plan supplier, FUJI JAPAN Elevator intergrates the elevator research, development,

design, manufacture, sales, installation, repair, maintenance, transformation into One FUJI JAPAN Elevator. It inherits the outstanding Japan manufacture technology. It introuces the advanced internation manufacture installations, combines with pioneer Japan elevator design concept.

The first-class R&D, design, production, site service groups bring about the secure reliable, outstanding elevators and escalators for vast clients. FUJI JAPAN Elevators accord with GB7588-2003 and European Enät standards. It passes ISO9001 Intermation Quality System Certification.

In normal production process, the strict and comprehensive product inspection and testing system ensures the superior elevators and escalators with excellent operation. FUJI JAPAN Elevator provides modern cities with the international product standards and operation experiences by the superior services. With the vigorous support of advanced management and innovative technology, it integrates with the advantageous resources to enhance its strength. It leads the elevator industry. It offers you the extraordinary Japan experience. This is also the unchanged pursuit of FUJI JAPAN Elevator.

メーカープロフィール Manufacturer Profile

KANEKO JAPAN (Kaneko Manufacturing Co., Ltd.) was founded in 1934. Having more than 90 years of experience Kaneko Japan is specialized in designing, manufacturing the elevator traction machine, Hydraulic elevator machine, control panel, safety equipment's and other spare parts. In shorty the company profile is presenting below

商 号	株式会社ケーエム
Company name:	KM Co., Ltd.
所在地	東京都港区新橋1丁目18番16号 日本生命新橋ビル9F (〒105-0004) TEL 0 (3735) 7111 FAX 03 (3735) 7781
Address:	9F, Nippon Life Shinbashi Building, 1-18-16 Shinbashi, Minato-ku, Tokyo (Postal Code 105-0004) TEL: 03 (3735) 7111 FAX: 03 (3735) 7781
創 業	1934年 (昭和9) 金子製作所
Established:	1934 (Showa 9) Kaneko Manufacturing Co., Ltd.
設 立	1948年 (昭和23) 有限会社 金子製作所
	1948 (Showa 23) Kaneko Manufacturing Co., Ltd., Ltd.
	1989年 (平成1) 販社として株式会社 ケーエムを設立
	1989 (Heisei 1) Established KM Co., Ltd. as a sales company
	2015年 (平成27) 株式会社 ケーエムへ
	株式会社 金子製作所を統合
	2015 (Heisei 27) Merged with Kaneko Manufacturing Co., Ltd. to become KM Co., Ltd.
資本金	2,000万円
Capital:	20 million yen
役 員	代表取締役 金子 純也
	専務取締役 川口 拓治
Directors:	Representative Director: Kaneko Junya
	Senior Managing Director: Kawaguchi Takuji
従業員数	35名 (2016年1月現在)
Number of employees:	35 (as of January 2016 Affiliated)
加入団体	一般社団法人日本エレベーター協会

東京エレベーター工業協同組合

Organizations:

Japan Elevator Association (General Incorporated Association)

Tokyo Elevator Industry Cooperative Association

拠点 Business Base

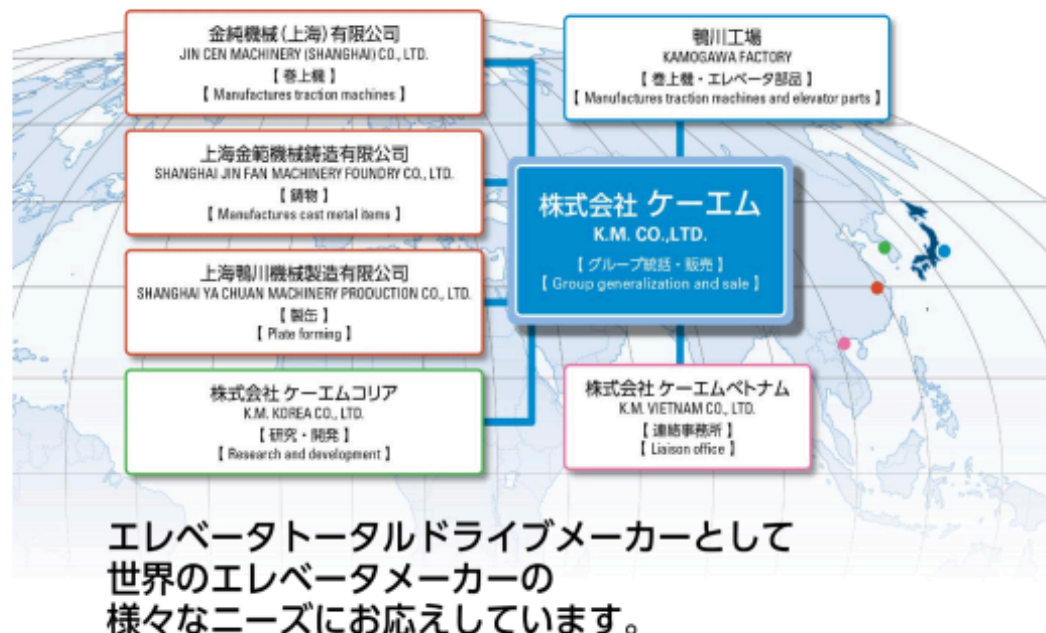

- ◆ エレベータ用巻上機
 - ・ウォームギアタイプ
 - ・ヘリカルギアタイプ
 - ・ギアレスタイプ
- ◆ 油圧エレベータ用パワーユニット
- ◆ 油圧エレベータ用ジャッキ
- ◆ コンペンシーブ組品
- ◆ セカンダリシーブ組品
- ◆ その他エレベータ用部品

- ◆ Traction Machines For Elevators
 - ・ Worm - Gear
 - ・ Helical - Gear
 - ・ Gearless Type
- ◆ Power Unit For Hydraulic Elevators
- ◆ Jack For Hydraulic Elevator
- ◆ Ass'y Compensation Sheave
- ◆ Ass'y Secondary Sheave
- ◆ Elevator Parts



KPM-200



KTM-60F



KHM-125

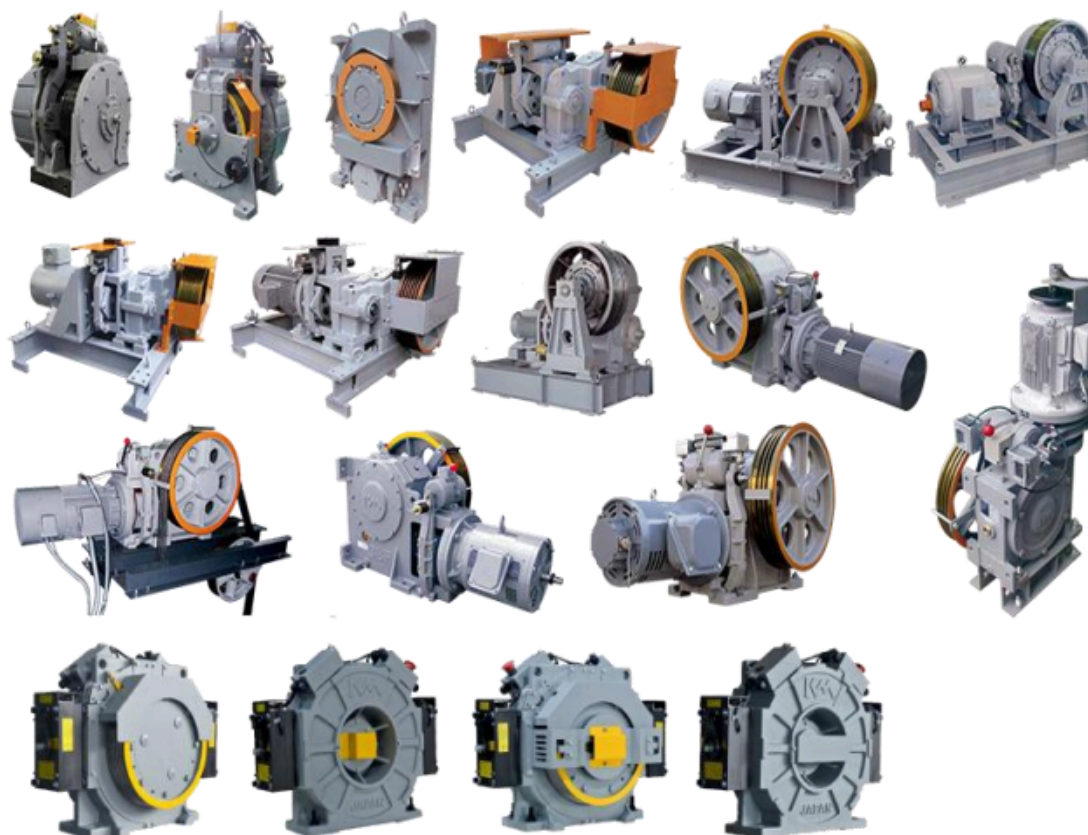

制御盤 Control panel

仕様	SPEC
電源	3相、200V~400V
周波数	50/60Hz
速度制御	フリープレス(専用制御)/多段速制御
停止回数	32停止(限)
速度	30~240m/min
用途	乗用/人荷用/貨物
制御方式	インバータ制御
メインCPU	32 bit MCU
駆動CPU	16 bit MCU
位置検出方式	エンコーダー(1,024~32,768 Pulse)
表示方式	Dot Matrix LED/液晶
グループ運転	4car

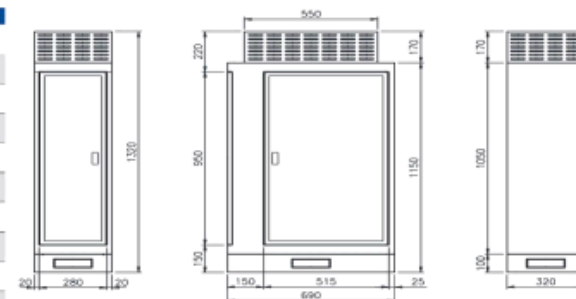

- ・戸開走行保護装置制御対応機能(UCMP)
- ・地震時、管制運転機能(5波・P波・R波)
- ・火災時、管制運転機能
- ・停電時、管制運転機能
- ・フリープレス(専用制御)及び多段速制御
- ・運行時間、開閉、ボタン動作回数記録機能
- ・自動増高測定
- ・自動停止階設定機能
- ・故障及び警告発生記録機能
- ・自動診断運転機能
- ・確認番号機能(カゴ呼ぶ)
- ・単式自動運転機能
- ・入力接点変更機能(A接点・B接点)
- ・カゴ照明&換気装置の自動OFF機能
- ・オート音声アナウンス機能(B2~13階)
- ・障害者呼び及び開きボタン動作機能
- ・Dot Matrix LED スクロール切替え機能
- ・故障ボタン検出機能
- ・専用運転機能
- ・機械室運転機能
- ・非運転階設定機能
- ・自動繰り返し運転機能

- ・両方口ドア設定機能
- ・運転手付き運転機能
- ・任意パーキング階設定機能
- ・逆方向カゴコール取り消し機能
- ・積載量最小・大・超過制限機能
- ・メンテ・コンソール接続機能
- ・スケジュール運転機能
- ・各階停止機能
- ・メインシステムアナログ入・出力制御機能
- ・特定階待機機能
- ・台風時・パーキング機能
- ・ホームランディング機能
- ・光電センサー、反転スイッチ異常時強制戸閉機能
- ・自動レベルリング補正機能
- ・ベットの専用機能
- ・気配りアナウンス機能
- ・お迎え機能
- ・いたずら呼びキャンセルON/OFF設定機能
- ・ドア開放時間調整機能(積載荷重)
- ・インターホン音声通信
- ・その他追加が必要な機能
- ・仮想階設定機能



UCMP ボード

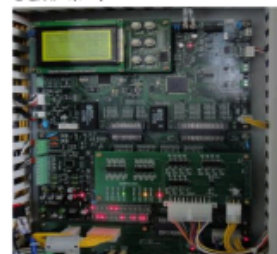

メインボード



据付け現場の写真



インバーター及び駆動部

仕様 SPECIFICATION	
電源 POWER SUPPLY	3相 200V~440V Three-phase, 200V~440V
周波数 FREQUENCY	50 / 60 Hz
速度制御 SPEED CONTROL	フリープレス (国内専用機) Free-press (exclusive control for EV)
停止機能 STOP FUNCTION	40秒止 (標準) 40 stops (Standard)
速度 SPEED	15~600m/min
用途 PURPOSE	車内/人専用/客用 Passenger / Passenger & Freight / Freight
制御方式 CONTROL METHOD	CANbus, RS485 / シリアル通信 CANbus, RS485 serial communication
位置検出方式 POSITION DETECT METHOD	エンコーダ Encoder
ブレーキ BRAKE	インクリメンタル/50Hz/COG/Endat+イノバンス (標準) Incremental/50Hz/COG/Endat+Inovance (Standard)
牽引機 TRACTION MACHINE	ベクトル・ベクトル Vector / Vector
制御方式 CONTROL METHOD	DSP Matrix LSI / 32bit DSP / 32bit DSP
動作モード DRIVE OPERATION	Scars

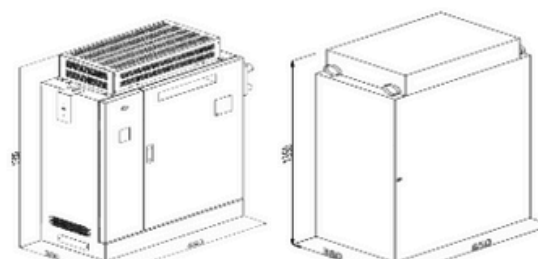

3.7kW-18.5kW制御盤
3.7kW 18.5kW Control panel

22kW-37kW制御盤
22kW 37kW Control panel

制御盤寸法
DIMENSIONS OF CONTROL PANEL

インバータ容量 INVERTER CAPACITY	電圧 VOLT	電流値 CURRENT	高さ×幅×奥行 (mm) L×W×D (mm)
3.7kW	三相電圧 220V	18A	650×300×1,300
5.5kW	三相電圧 220V	27A	650×300×1,300
7.5kW	三相電圧 220V	33A	650×300×1,300
11.0kW	三相電圧 220V	48A	650×300×1,300
15.0kW	三相電圧 220V	60A	650×300×1,300
18.5kW	三相電圧 220V	74A	650×300×1,300
22.0kW	三相電圧 220V	91A	650×300×1,350
30.0kW	三相電圧 220V	112A	650×300×1,350
37.0kW	三相電圧 220V	150A	650×300×1,350

KMオリジナル機能

機能面

- 手動スイッチの優先順位 (かご上 > かご内 > ピット > 制御盤) は、国内 EL メーカー仕様と同様
- 操作盤スイッチ BOX、PIリモコンは、国内 EL メーカー仕様と同様
- 各々警報運転すべて、昇降機技術基準および JEAS 準じる地震、火災、停電、冠水、自動診断、単式運転機能
- かご内・車場表示 (一部分) は、日本語対応
- オートアナウンス機能は、日本語対応

ハード面

- 安全関連の信号は、従来のハード (電線、リレー) で行う
- 国内メーカー (富士等) または、グローバル用品 (シュナイダー等) を利用
- 用品容量選定は、国内 EL メーカー基準に準じる

その他

- タブレットアプリにて、制御盤保守・調整可能
- リモート点検システム適用可能



ORIGINAL SPEC. MADE BY K.M.

Functional aspect

- The priority of manual switches (car top > inside car > pit > control panel) follows the specifications of domestic elevator manufacturers.
- Switch box of operation board, and PI remote control are in accordance with the specification of domestic elevator manufacturers.
- All the individual control operations comply with elevator technical standards and JEA regulations.
Functions for alerting earthquake, fire, power outage, and flooding, and for self-diagnosis, a single automatic operation.
- The display inside cabin & lobby (partially) supports Japanese.
- The auto-announcement function supports Japanese.

Hardware aspect

- Safety-related signals will continue to be implemented through hardware (wires, relays) as before
- Utilize products which are made by domestic maker (such as Fuji, etc.) or any other global maker (such as Schneider)
- The selection of product capacity is based on the standards of domestic elevator manufacturers.

Others

- Maintenance & adjustment of the control panel are available via a tablet APP
- Applicable to remote inspection system

主要構成 (一体型)

MAIN COMPOSITION (INTEGRATED TYPE)

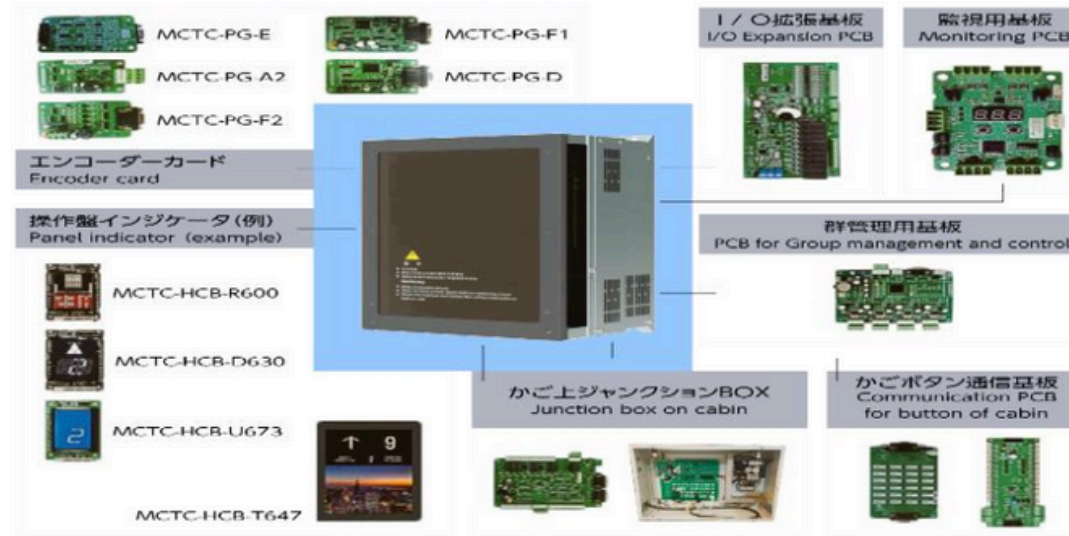

特 長

- 制御・インバータが一体機（反応が速い）
- クリープレス機能
- ランニングドアオープン機能
- 自動イン칭機能
- スマートレベル調整機能（操作盤ボタン操作）
- 過負荷電流
 - 150% 定格60秒
 - 200% 定格10秒
- 起動トルク200%
- 着床ゼロ速度保持
- アンチロールバック制御（ロードセルレス）

Features

- Integration of controller & inverter (fast reaction)
- Creep-less Function
- Running door open Function
- Automatic inching Function
- Smart level adjustment Function (panel button operation)
- Overload current
 - 150% rated 60s
 - 200% rated 10s
- Starting torque 200%
- Leveling speed retains 0m/s
- Control with Anti-rollback (without loadcell)



半世紀にわたり積み重ねてきた確かな実績。
その確かな技術を、世界に向けて提供していきます。

■会社概要

敷地面積	6,500㎡
工場面積	2,500㎡
製造品目	巻上機、エレベータ用部品
主要設備	オークマ製マシニングセンタ／ 600H - R オークマ製マシニングセンタ／ 800H - R NCターニング 汎用ターニング NC旋盤 門型マシニングセンター エレベータテストタワー

KAMOGAWA FACTORY

For half of a century we have been building a foundation of reliable results. These results are the platform from which we are able to send our credible technology out into the world.

■COMPANY PROFILE

Lot area	6,500㎡
Factory area	2,500㎡
Products	Traction Machine, Elevator Parts
Main Equipment	600H - R Machining Center by OKUMA 800H - R Machining Center by OKUMA NC Turning Machine Universal Turning Machine NC Lathe Machine Double - Column Type Machining Center Test Tower For Elevator

千葉県鴨川市にある鴨川工場は、KMが世界に誇る技術開発の中枢です。ひときわ目を引くのが、最新鋭のメカトロニクスを集約したテストタワー。エレベータパーツメーカーでは類のない規模で、当社の技術開発に対する積極的な姿勢を示すシンボルです。安全性と快適性を限界まで追究した技術は、ここ南房総の地から世界に提供されます。

Our Kamogawa factory located in Kamogawa City, Chiba is the center of our technological development. The mechatronics test tower in there receives a lot of attention. This outstanding scale also symbolizes our devotion to Technological development. KM is engaged in studying and pursuing elevator comfort and safety from here South BOSO area to the World.



■会社概要

商 号	金純機械(上海)有限公司
設 立	1996年
資本金	USD1,300,000
敷地面積	15,300㎡
工場面積	8,000㎡
製造品目	エレベータ用巻上機(ウォーム・ヘリカル・ギアレス)
主要設備	オークマ製 マシニングセンタ 600H×2台 オークマ製 マシニングセンタ 800H×1台 MAZAK製 マシニングセンタ H-800×1台 MAZAK INTEGREX 400-Ⅲ×1台 NC門型フライス盤(3200×1700)×1台 NCターニング(YV550~1600)×5台 NC旋盤×5台 マシニングセンタ (v)×3台 三次元測定器(Global status121510)×1台
従業員数	125名(2016年1月現在)
技術研修	毎年2~3名、鴨川工場にて3年間、組立および技術研修実施。
認 証	ISO 9001:2008



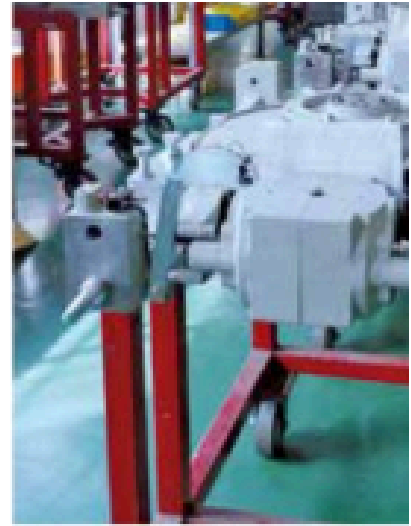

■会社概要

商号	上海鴨川機械製造有限公司
設立	2002年
資本金	800万元(RMB)
敷地面積	4,000㎡
工場面積	3,000㎡
製造品目	製缶製品の製造販売／生産設備・治工具等 (各種マシン・巻上機・ギアケース等)の製造
主要設備	NCカッター(CXE - 3000)×2台 油圧ベンダー(WC67Y - 3000・4000) 油圧シャーリング(QC12Y - 6*2500) 油圧シャーリング(QC12Y - 12*3200) CO ₂ ガス溶接機(NB - 500A)
従業員数	26名(2016年1月現在)



■会社概要

商号	上海金範機械製造有限公司
設立	1997年
資本金	USD548,100
敷地面積	10,000㎡
工場面積	鋳造工場4,000㎡／その他の工場1,200㎡
製造品目	ねずみ鋳鉄 FC150～300 球状黒鉛鋳鉄 FCD400～700 低合金鋳物
鋳物精度 (金型)	CT 9 - 11級(金型) 表面粗さ 100S
主要設備	フラン樹脂自硬性混練機 10t/h×4台 フラン樹脂自硬性混練機 5t/h×2台 砂再生処理システム 10t/h 電気炉 1.5t×2基 ショットプラスト 1t×1基・3t×2基 アムスラー万能試験機 30t(WA- 300N) カントバック(ARL)×1台 CEメータ×1台 鋳物組織顕微鏡×1台 電気焼鈍炉 10t×1台 各種硬度計 超音波金属検査機×1台 三次元測定器 型工場(木型・金型)
従業員数	95名(2016年1月現在)
生産量	400t/月
輸出	全体の50%を輸出(日本・米国)
認証	ISO 9001:2008

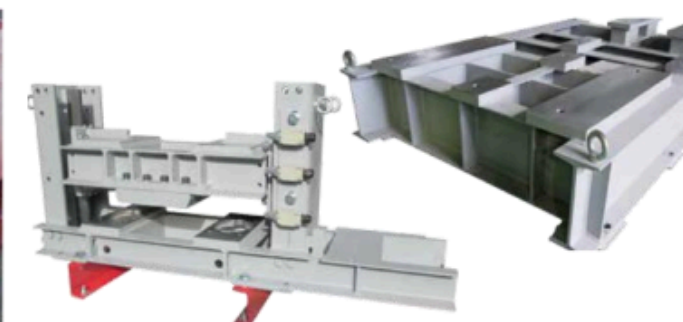

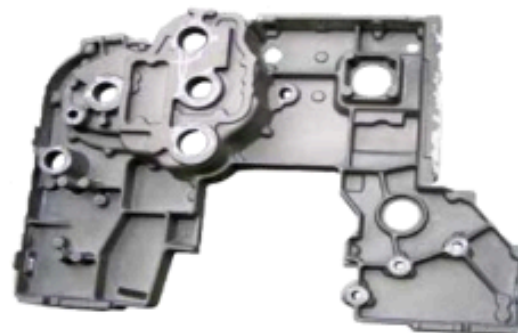

TECHNICAL STRENGTH

▼ Effective, Speedy and High-End Intellectual Design

It gives first priority to effectiveness in vertical transport field. In order to fully optimize the service efficiency of the elevator system, FUJI JAPAN elevator fulfills the intellectual managements such as multi-computer, modular and network control etc, through fully computerized intellectual control system.

It instantly feeds back the elevator running conditions. It provides the passengers with the most efficient gold-collar services.



▼ Serial Communication Technology

It adopts the network communication, which brings great reduction of the wires, enhancement of the reliability and less installation period.

▼ Microcomputer Group Supervision Management System

Duty on/off rush-hour running mode: It satisfies the running requirements in the rush hours of duty on/off the public occasions in the office building and etc.

Even operation mode: It adopts the minimized waiting period distribution principle with the prompt and reasonable elevator response.

Idle running mode: The elevators have been evenly distributed in the designated area to wait far call in idle times in order to guarantee the quick and timely response towards the outer calls.

▼ Remote Control System Ensures Intelligent Supervision

Through wire or wireless communication, the operation status and success situation of passengers in elevators are real-time protected in remote control center. Malfunctions are excluded before occurrence and nip them in the bud to ensure the safety of passengers.

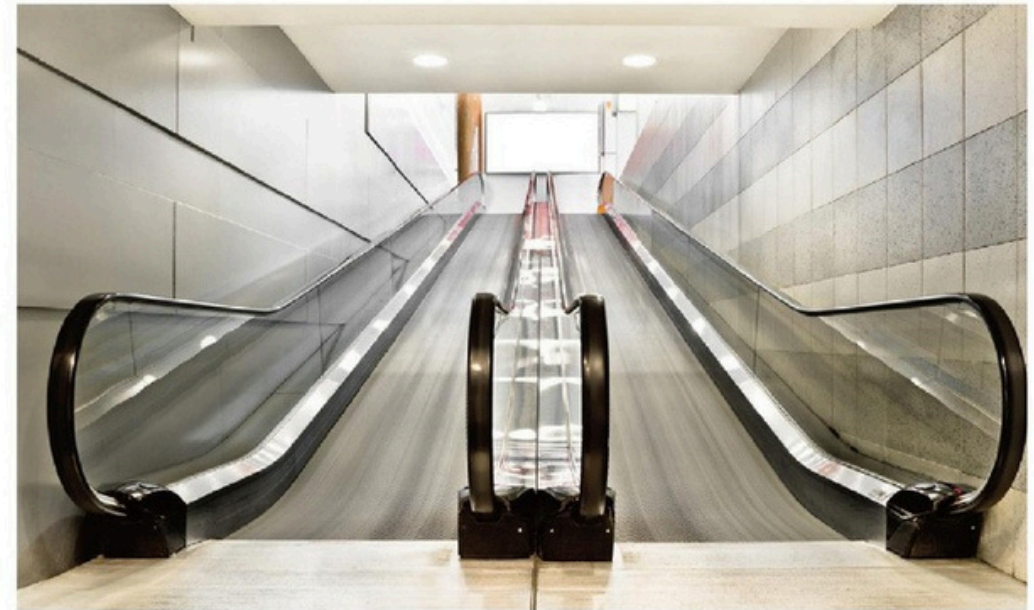

▼ Mute Braking Control Technology

- ⌘ Compared with the traditional voltage open-loop control.
- ⌘ It applies the more accurate current closed-loop control mode.
- ⌘ It controls various steps of action speed and braking torque of the brake.
- ⌘ It greatly reduces noise in brake action.
- ⌘ It enhances the comfortable travel.

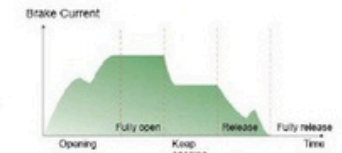

▼ Top Advanced Door Operator System

The door operator control system of FUJI JAPAN elevator applies dual control system. One group is controlled by main controller of control cabinet.

The other one is by door operator controller, which greatly reduces non-opening accidents due to trouble of door machine control.

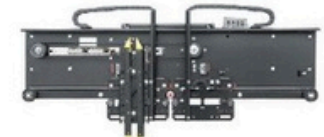

TOP TECHNICAL

To Give You A Wholly New Experience



The business field, high efficiency first, in order to fully optimize the service efficiency of business of elevator. FUJI JAPAN by using the computer intelligent control system. Realizes the multi microcomputer module, network control and other intelligent management. The elevator operation provides instant feedback, offers the most efficient service for passengers.

Supervision System

Group supervision system of FUJI JAPAN Elevator is high-speed network processing serve center. It can calculate the best elevator running mode in the building. The out-standing traffic control performance comes from parallel "fuzzy computing" method.

The processing system is based upon the quick and effective genetic algorithm. It can choose the best travel route for the passengers so that they get the prompt service under any of the traffic conditions.

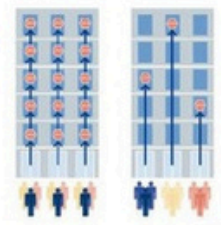

Fingerprint Identification

Layer with finger print identification of the elevator control system is an utility model involves the electronic technology, and control the use of fingerprints identification residents elevator parked in the designated floor, make the multi-storey building entrance guard management improved, peaking time to other person into the building occupants harassment problems has solved.



Intelligent Card(IC) System Realizes Scientific and Safe Management of Rights and Authority

In accordance with the requirements of users, intelligent IC card management system can be equipped to conduct real-name system or authority management, effectively avoid access of visitors and improve the safety of the building.



Through the contact less card reader at the entrance floor, automatically login uplink button.



After elevator arrived, it would automatically go to the target floor, buttons for other floors would not work even if you click them.

ENERGY SAVING FROM FUJI JAPAN

Energy Feedback Technology

Highly energy-saving energy feedback technology is based upon double-PWM control. It feeds back the pollution-less regenerated green electric energy that is originally consumed by energy-consumption resistance to other power equipment. It thus averagely saves over 30% of energy compared with the ordinary VVVF elevators. It completely satisfied the related national electric energy quality standards.

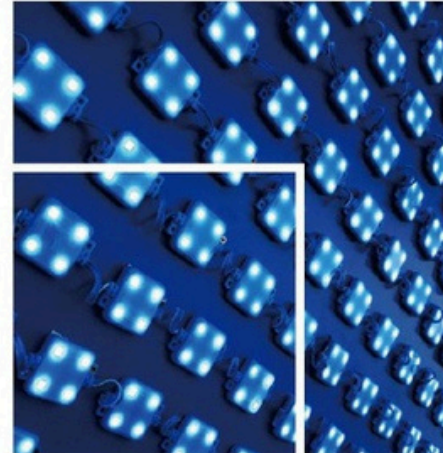
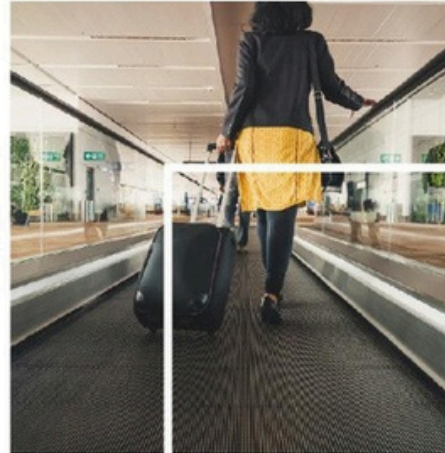
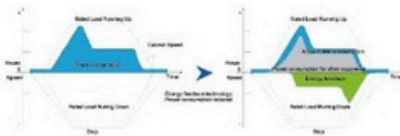

LED Automatic Lighting in the Car

It adheres to the product idea of FUJI JAPAN Elevator. FUJI JAPAN elevator innovatively applies LED car lighting device. It has the advantages, such as safe, effective, radiation-free, easy maintenance etc. It is a model example of energy-saving in modern and well-off life configuration of passenger elevator series includes automatic shut-off function of car enjoying and fan. It gives a full play of human-centered design to FUJI JAPAN Elevator.

New Generation Permanent Magnet Synchronous Gearless Traction Machine

It can save over 40% of energy. It needs no grease renewal without oil pollution. Which brings peacefulness and refreshment.

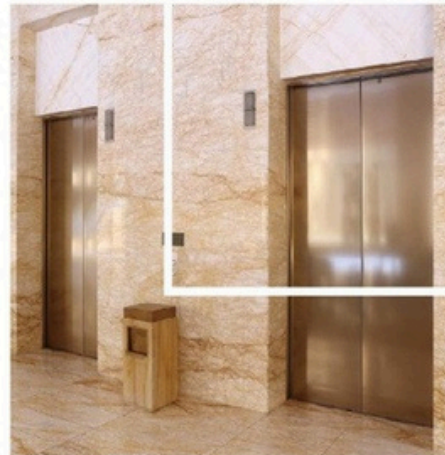

Five Advantages

- It is non-calorific converts over 90% of electric energy into optical energy.
- Longer service life and fewer power consumption.
- The elevators consume 20%~35% less of power.
- It does not add heavy metals during chip assembling and processing. It excludes any hazardous materials.
- It can be recycled and reused after being discarded.

HIGH SPEED ELEVATOR

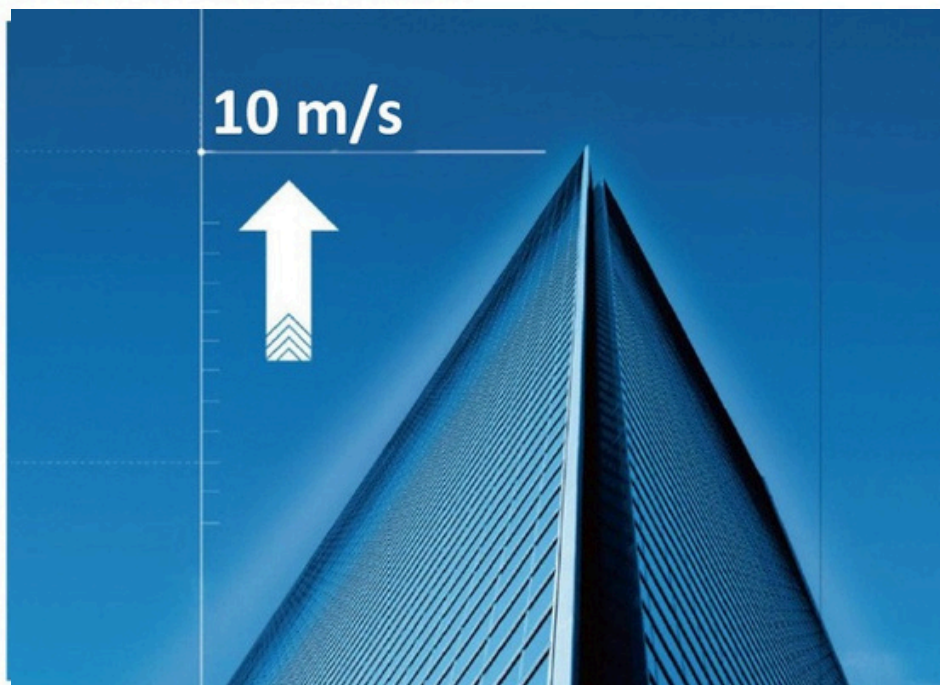

▼ The Extremely Comfortable Travel

A shock-absorbing device is set between the car body and holder to isolate vibration. It superiorly buffers vibration during the elevator running process. It reduces the car vibration and prompts the comfortable travel to vast passengers. The combined car wall connection ensures mute effects in the car, the stable and enclosed air pressure.

▼ High Speed Serials Specification Table

Target market	The medium & high grade of the commercial buildings
Control system	VVVF
Traction machine	Permanent magnet synchronous & gearless
Door machine	VVVF door machine
Net car height	2600mm
Rated load(kg)	1050/1150/1250/1350/1600/2000
Rated speed(m/s)	2.5/3.0/4.0/5.0/6.0/7.0
Max lighting height(m)	120/150/180/220/260/300
Max group supervision No.	8

▼ Car Vibration System

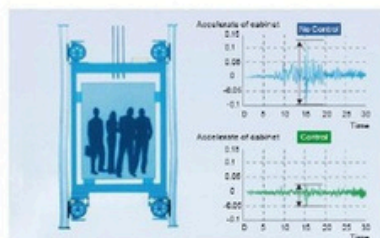

High Speed Elevator Construction Sketch

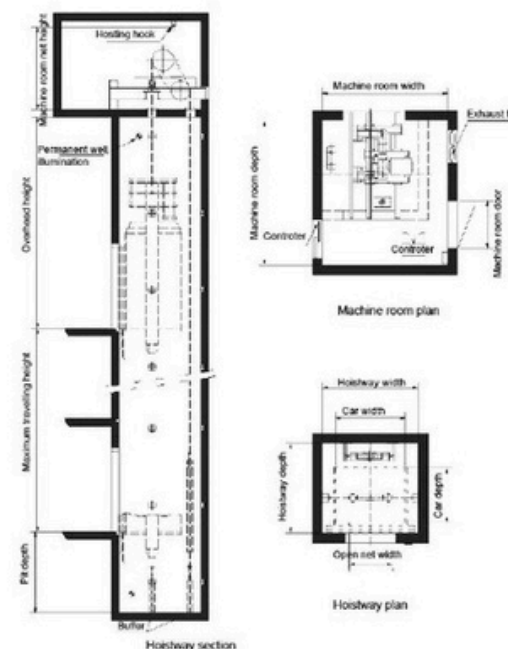

High speed elevator parameter table

Load (kg)	Speed (m/s)	Size of entrance (mm)	Size of car (mm)	Size of hoistway (mm)	Size of machine room (mm)	Overhead height (mm)	Pit depth (mm)	Max travelling height (mm)
800	2.5	800*2100	1400*1350*2450	2200*2250	3000*3700	6200	2200	150
1000	2.5	900*2100	1600*1400*2450	2200*2250	3000*3700	6200	2200	150
	3.0					5500	3100	150
	3.5					5800	3700	180
	4.0					6200	4000	180
1050	2.5	900*2100	1600*1500*2450	2200*2300	3000*3700	6200	2200	150
	3.0					5500	3100	150
	3.5					5800	3700	180
	4.0					6200	4000	180
1150	2.5	900*2100	1600*1400*2450	2450*2300	3200*3700	6200	2200	150
	3.0					5500	3100	150
	3.5					5800	3700	180
	4.0					6200	4000	180
1250	2.5	900*2100	1950*1400*2450	2600*2300	3200*3700	6200	2200	150
	3.0					5500	3100	150
	3.5					5800	3700	180
	4.0					6200	4000	180
1350	2.5	1100*2100	1950*1500*2450	2600*2350	3200*3700	6200	2200	150
	3.0					5500	3100	150
	3.5					5800	3700	180
	4.0					6200	4000	180
1600	2.5	1100*2100	1950*1750*2450	2600*2600	3200*4000	6200	2200	150
	3.0					5500	3100	150
	3.5					5800	3700	180
	4.0					6200	4000	180
2000	2.5	1100*2100	2000*1950*2450	2650*2800	3200*4000	6200	2200	150
	3.0					5500	3100	150
	3.5					5800	3700	180
	4.0					6200	4000	180

Note: Reference only, for detail information, please contact FUJI JAPAN elevator.

SMALL MACHINE ROOM ELEVATOR



It Fulfills Small Cost

Small volume traction machine combines with integrated controller, so that it makes the machine room size same with well size. It covers the equal area as that of the well. At the same time of reducing the machine room height it beautifies the building outlook. It fulfills super small standard of machine room space and building cost.

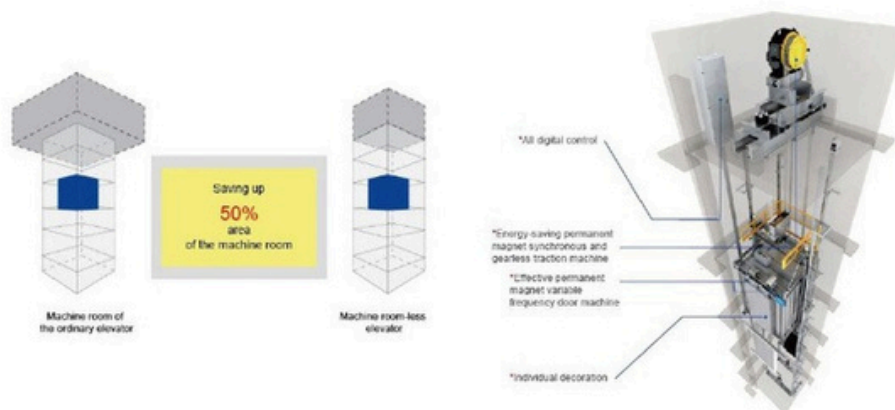

Small Machine Room Elevator Construction Sketch

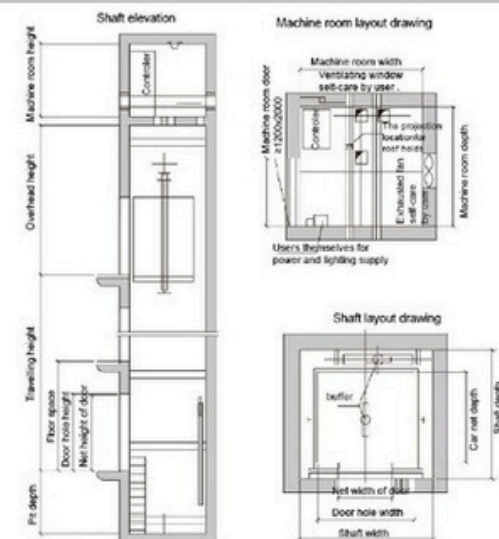

Small machine room elevator parameter table

Persons	Load (kg)	Speed (m/s)	Net size of car(mm)	Net size of door(mm)	Shaft size(mm)			Machine room size(mm)	
			C.WxG.DxD.H	2P Central opening D.WxD.H	H.WxH.D	HR.H	PIT	MR.WxMR.D	MR.H
6	450	1.0	1400*850*2300	800*2100	2000*1500	4000	1500	2000*1500	2500
		1.5/1.75				4200	1500		
		1.0				4400	1600		
8	630	1.0	1400*1100*2300	800*2100	2000*1720	4200	1500	2000*1720	2500
		1.5/1.75				4400	1600		
		1.0				4200	1500		
10	800	1.0	1400*1350*2300	800*2100	2000*1970	4200	1500	2000*1970	2500
		1.5/1.75				4400	1600		
		2.0				4800	2000		
13	1000	2.5	1600*1450*2300 1100*2100*2300 (Residence/stretcher elevator)	900*2100	2200*2120 2100*2500 (Residence/stretcher elevator)	4800	1800	2200*2120 2100*2500 (Residence/stretcher elevator)	2500
		3.0				5200	2600		
		3.5				5500	3100		
16	1250	4.0	1900*1450*2300	1100*2100	2500*2150	6000	3850	2500*2150	2500
		1.0				4200	1500		
		1.5/1.75				4400	1600		
18	1350	2.0	1900*1550*2300	1100*2100	2500*2250	4800	1800	2500*2250	2500
		2.5				5200	2600		
		3.0				5500	3100		
21	1600	3.5	1900*1800*2300	1100*2100	2500*2500	6000	3850	2500*2500	2500
		4.0				6350	4300		
		1.0				4200	1500		
26	2000	1.5/1.75	1900*2200*2300	1100*2100	2700*2700	4500	1500	2700*2700	2500
		2.0				4700	1600		
		1.0				4500	1500		

Note: Reference only, for detail information, please contact FUJII JAPAN elevator.

MACHINE ROOM-LESS ELEVATOR



Greatness in Trivialness Intellectual and Outstanding

FUJII JAPAN machine room-less elevator series resolves the restriction to the elevator in the construction, building cost, building design style, use range. At the same time of saving the space and cost, it provides the passengers with upper level intellectual, effective and stable travel.

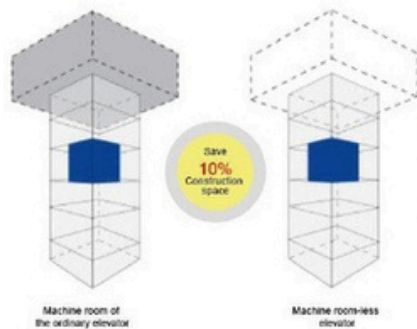

*Well optimal design has effectively save 10% construction areas.
*Being equipped with green drive and energy conservation device, energy conservation has reached 35%.
*Machine room-less concept makes the design of building more free and comfortable.



Machine Room-less Elevator Construction Sketch

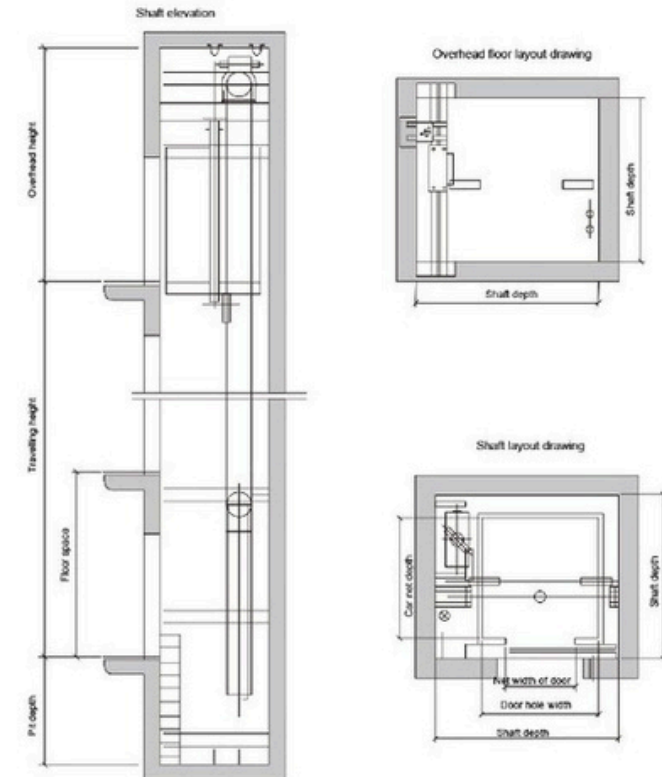

Machine room-less elevator parameter table

Persons	Load (kg)	Speed (m/s)	Net size of car(mm)	Net size of door(mm) D.WxD.H	Shaft size(mm)		
			C.WxC.DxD.H	2P Central opening	H.WxH.D	HR.H	PIT
6	450	1.0	1100*1100*2300	800*2100	2050*1850	4200	1500
8	630	1.0	1400*1100*2300	800*2100	2250*1800	4200	1500
		1.5/1.75				4400	1600
10	800	1.0	1400*1350*2300	800*2100	2250*1850	4400	1600
		1.5/1.75				4600	1800
		2.0				4800	2000
		2.5				4800	2000
13	1000	1.0	1500*1550*2300	900*2100	2350*2150	4200	1500
		1.5/1.75				4400	1600
		2.0				4600	1800
		2.5				4800	2000
21	1600	1.0	1900*1800*2300	1100*2100	2850*2400	4500	1500
		1.5/1.75				4700	1600
		2.0				4800	1800
		2.5				5100	2000
26	2000	1.0	1900*2200*2300	1100*2100	2900*2600	4500	1500
		1.5/1.75				4700	1600
		2.0				4900	1800

Note: Reference only, for detail information, please contact FUJII JAPAN elevator.

SQUARE OBSERVATION ELEVATOR



✓ Superior Car Wall

It adopts highly secure safety laminated glass. It is transparent. The passengers might appreciate the busy and prosperous city sight through the transparent car wall. Lamination layer in laminated glass resists radiation. It buffers sound-wave vibration and isolates the sound. Large area car wall glass design shows smooth and beautiful lines. It beautifies the elevator car outline. Furthermore, the buildings are attractive.

✓ Super large viewing field

Full transparent lift car design can maximize the field of view. Through the visual extension, passengers can have a panoramic view of all the beautiful scenery.

✓ Multiple lift car shapes

Round, square and rhombic and other lift car shapes are optional, perfectly corresponding to different architectural styles.



Square Observation Elevator Construction Sketch

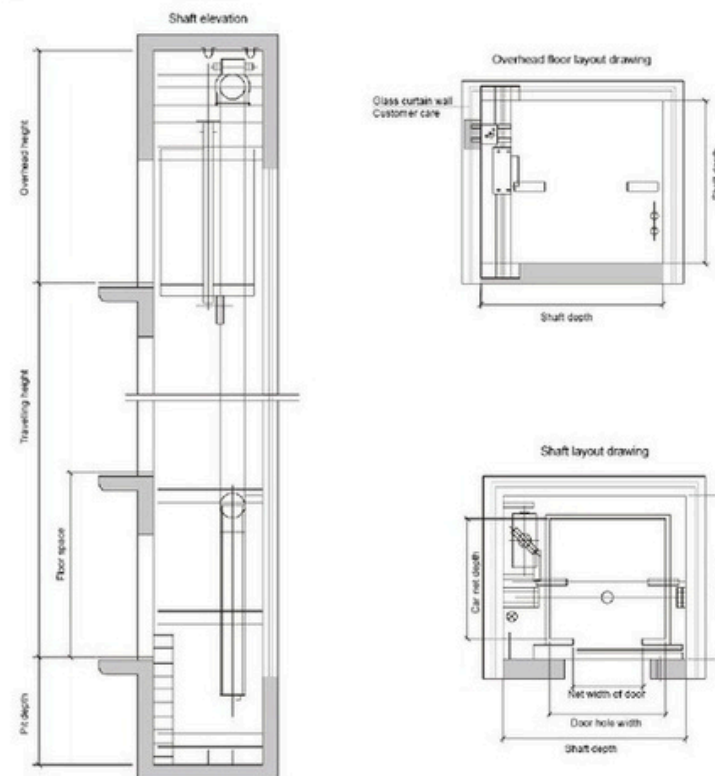

Square machine room/machine roomless elevator parameter table

Persons	Load (kg)	Speed (m/s)	Net size of car (mm)	Net size of door (mm)	Shaft size (mm)		
			C.WxH.DxD.H	2P Central opening	H.WxL.D	HxL.H	PIT
6	450	1.0	1100*1100*2300	800*2100	2050*1850	4200	1500
8	630	1.0	1400*1100*2300	800*2100	2250*1900	4200	1500
		1.5/1.75				4400	1600
		2.0				4600	1700
10	800	1.0	1400*1350*2300	800*2100	2250*1850	4200	1500
		1.5/1.75				4400	1600
		2.0				4600	1700
13	1000	2.5	1500*1550*2300	900*2100	2350*2150	4800	2000
		1.0				4200	1500
		1.5/1.75				4400	1600
21	1600	2.0	1900*1800*2300	1100*2100	2350*2400	4800	1800
		2.5				5100	2000
		1.0				4500	1500
26	2000	1.5/1.75	1900*2200*2300	1100*2100	2900*2600	4700	1600
		2.0				4900	1800
		1.0				4500	1500

Note: Reference only, for detail information, please contact FUJII JAPAN elevator.

SEMICIRCLE OBSERVATION ELEVATOR

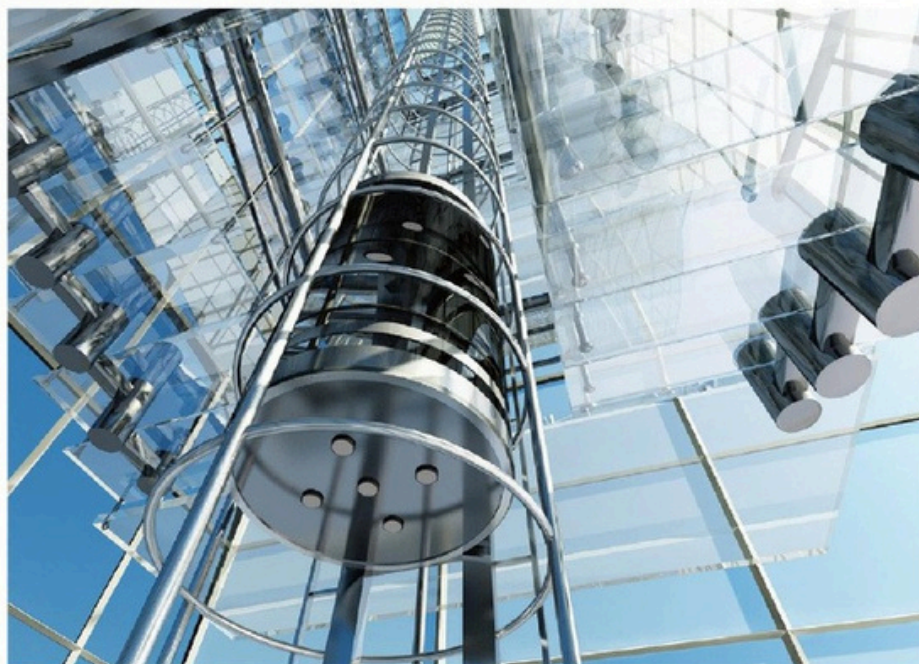

Outer Glass Hood

It harmoniously combines with the building and surrounding. Panoramic elevator is part of the building. It also adds a mobile charming scene for the building.

Outstanding sound insulation

The structure of the lift car is further optimized, which facilitates the elevator to achieve excellent sound insulation effect and customers to have quiet and steady using experience.

Diversified decoration design

There are a series of optional materials and colors for hoistway doors, handles and lift car walls, thus truly realizing individualized customized services.



Semicircle Observation Elevator Construction Sketch

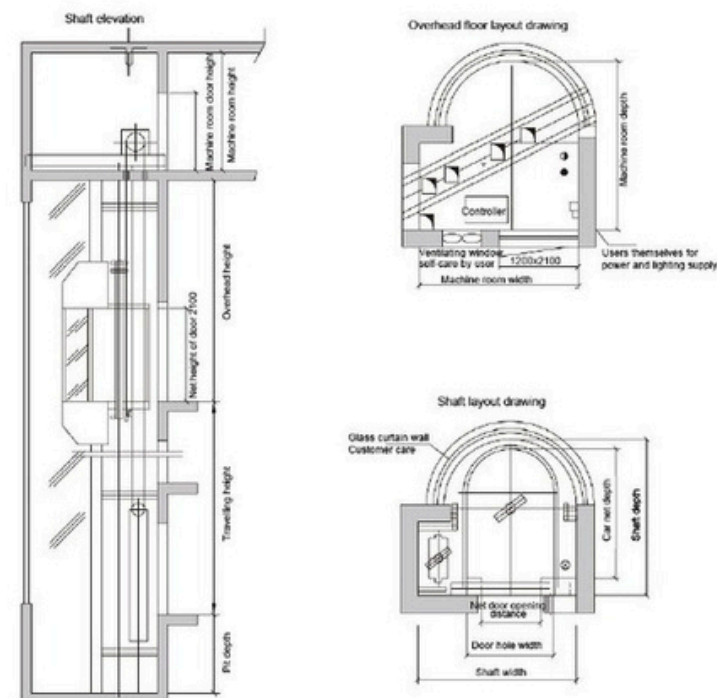

Semicircle machine room/machine roomless elevator parameter table

Persons	Load (kg)	Speed (m/s)	Net size of car (mm)	Net size of door (mm)	Shaft size (mm)			Machine room size (mm)	
			C WxG DxH	2P Central opening	H WxH D	MR H	PIT	MR WxMR D	MR H
8	630	1.0	1100*1600*2300	700*2100	2200*2185	4500	1500	2200*2185	2500
		1.5/1.75				4700	1600		
		2.0				4900	1800		
10	800	1.0	1200*1800*2300	800*2100	2300*2355	4500	1500	2300*2355	2500
		1.5/1.75				4700	1600		
		2.0				4900	1800		
13	1000	1.0	1300*1850*2300	900*2100	2400*2535	4500	1500	2400*2535	2500
		1.5/1.75				4700	1600		
		2.0				4900	1800		
16	1250	1.0	1400*2150*2300	900*2100	2500*2600	4500	1500	2500*2600	2500
		1.5/1.75				4700	1600		
		2.0				4900	1800		
18	1350	1.0	1500*2150*2300	1000*2100	2600*2600	4500	1500	2600*2600	2500
		1.5/1.75				4700	1600		
		2.0				4900	1800		
21	1600	1.0	1500*2450*2300	1000*2100	2600*2600	4500	1500	2600*2600	2500
		1.5/1.75				4700	1600		
		2.0				4900	1800		
26	2000	1.0	1700*2600*2300	1100*2100	2800*3050	4500	1500	2800*3050	2500
		1.5/1.75				4700	1600		
		2.0				4900	1800		

Note: Reference only, for detail information, please contact FUJII JAPAN elevator.

HOSPITAL ELEVATOR



Warm Concern A Beautiful Humanity World

FUJI JAPAN hospital elevators are not just used in delivering passengers. Because of its use particularity, it has special and strict requirements to the elevator use properties. FUJI JAPAN hospital elevator can accurately control the elevators' running speed. It brings about the smooth and comfortable travel.

FUJI JAPAN hospital elevator lays special importance upon the humane design. It fully optimizes the car structure. It satisfies the clients' use requirements to the greatest extent. It creates a peaceful and graceful space for vast passengers.

FUJI JAPAN hospital elevator satisfies the needs of emergency patients' delivery. It applies humanization design and is equipped with a full set of top equipments. It is smooth and comfortable in running.



Hospital Elevator Construction Sketch

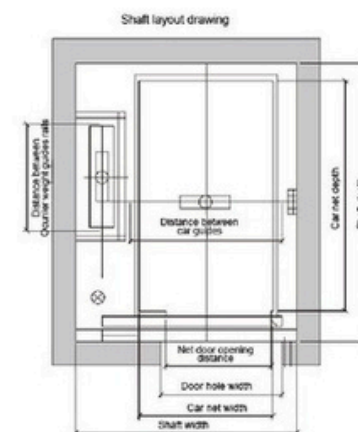
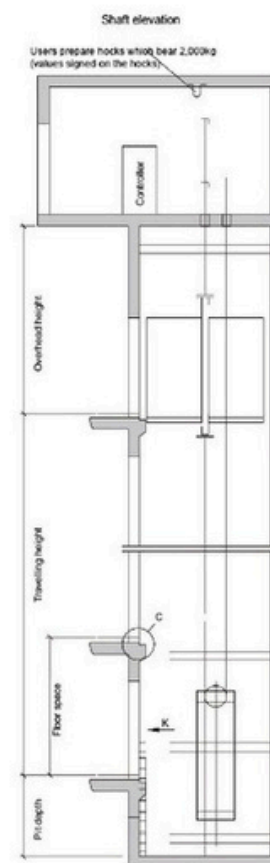

Hospital elevator parameter table

Persons	Load (kg)	Speed (m/s)	Net size of car(mm)	Net size of door(mm)	Shaft size(mm)			Machine room size(mm)	
			C WxG DxH	D WxD H	H WxH D	HR H	PIT	MR WxMR D	MR H
21	1600	1.0	1400*2400*2300	1100*2100	2550*2500	4500	1500	2550*2900	2500
		1.5/1.75				4700	1600		
		2.0				4900	1800		
		2.5				5100	2000		
		3.0				5300	2200		
24	1800	1.0	1600*2400*2300	1200*2100	2750*2900	4500	1500	2750*2900	2500
		1.5/1.75				4700	1600		
		2.0				4900	1800		
		2.5				5100	2000		
		3.0				5300	2200		
26	2000	1.0	1700*2400*2300	1200*2100	2850*2900	4500	1500	2850*2900	2500
		1.5/1.75				4700	1600		
		2.0				4900	1800		
		2.5				5100	2000		
		3.0				5300	2200		

Note: Reference only, for detail information, please contact FUJI JAPAN elevator.

HOME ELEVATOR



▼ Your Perfect Life is Comfortable and Relaxing

The humanization design decorates your noble life space. We enhance your life grade in the times of high & new tech. FUJI JAPAN home elevator brings about a more convenient and high-grade life.

It displays the outstanding properties in a limited space. It has no machine room. Extremely small top-floor height can match with various old and new residences. Relying on the standard track installation system, the elevator can be installed more quickly and conveniently. In addition, the smooth start and leveling system bring about the rare stable elevator operation. Therefore you feel more comfortable in the elevator travel.

▼ The Characteristics of Home Elevator

*No need of traditional machine room, without any construction cost increased. Specially designed rucksack frame for the home elevator with traction ratio 2:1 VVVF drive technology. FUJI JAPAN home elevator appropriate micro processing control.

*Slide + roller composite guide shoe.

*The appropriate traction machine bracket is fixed on the guide rail.

The building will not have any load.

*We apply 220V single-phase home elevator special machine.

*Automatic special door machine, synchronous timing belt transmission, TUV CE Certification passed.

*Comply with home elevator national standard GB/T21739-2008.



Home Elevator Construction Sketch

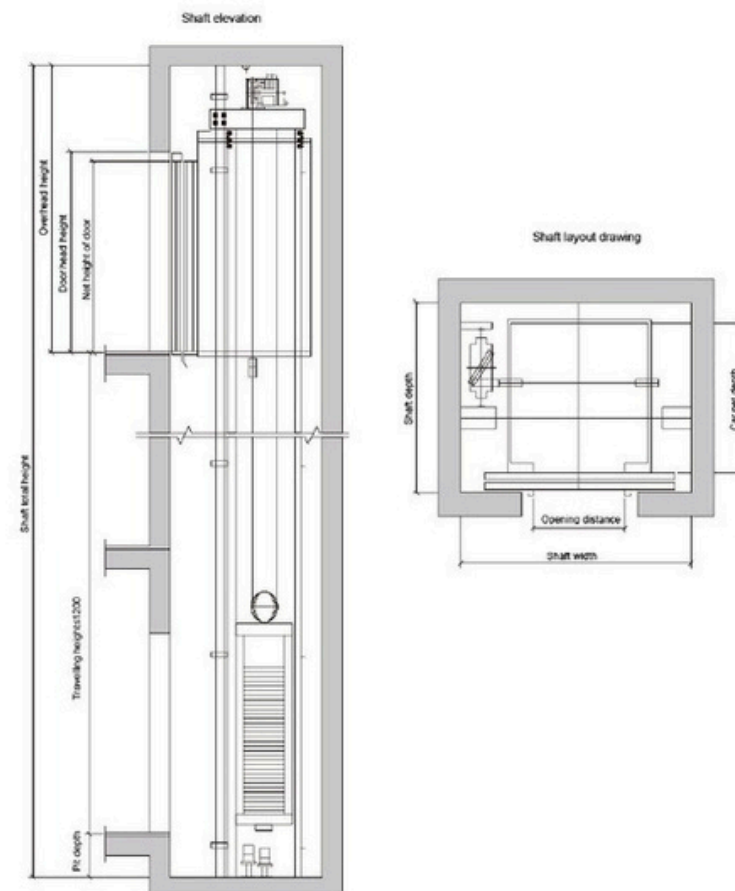



Home elevator parameter table



Persons	Load (kg)	Speed (m/s)	Net size of car (mm)	Net size of door (mm) D: W x D: H	Shaft size (mm)		
			C: W x C: D x D: H	2P: Central opening	H: W x L: D	H: R: L: H	P: I: T
3	200	0.4	800*1150*2200	700*2000 Side door	1400*1500	3500	800
4	320	0.4	950*1300*2200	700*2000	1800*1800	3500	800
5	400	0.4	1200*1300*2200	800*2000	1850*1800	3500	800

Note: Reference only, for detail information, please contact FUJI JAPAN elevator.

PERFECT FUNCTION

★ Standard Function

 Travel Function	VVVF drive	Motor rotating speed can be precisely adjusted to get smooth speed curve in lift start, travel and stop and gain the sound comfort.
	VVVF door operate	Motor rotating speed can be precisely adjusted to get the more gentle and sensitive door machine start/stop.
	Independent running	The lift can not respond to outer calling, but only respond to the command inside the car through the action switch.
	Automatic pass without stop	When the car is crowded with the passengers or the load is close to preset value, the car will automatically pass the calling landing in order to keep maximum travel efficiency.
	Automatically adjust door opening time	Door open time can automatically adjusted according to the difference between landing calling or car calling.
	Reopen with hall call	In the door shutting process, press reopen with hall call button can restart the door.
	Express door closing	When the lift stops and opens the door, press door-shut button, the door will be closed immediately.
	Car stops and door open	The lift decelerates and levels, the door only opens after the lift comes to a complete stop.
 Safety Function	Command register cancel	If you press the wrong floor command button in the car, twice continuous pressing of same button can cancel the register.
	Photocell protection	In the door open and shut period, infrared light that covers the whole door height is used to probe the door protection device of both the passengers and objects.
	Designated stop	If the lift can not open the door in the destination floor out of some reason, the lift will close the door and travel to the next designated floor.
	Overload holding stop	When the car is overload, the buzzer rings and stops the lift in the same floor.
	Anti-stall timer protection	The lift stops operation due to slippery traction wire rope.
	Start protection control	If the lift does not leave door zone within the designated time after it gets started, it will stop the operation.
	Inspection operation	When the lift enters into inspection operation, the car travels at inching running.
	Fault self diagnosis	The controller can record 62 latest troubles so as to quickly remove the trouble and restore the lift operation.
 Man-machine Interface	Repeated door closing	If the lift can not close the door due to certain obstacle or interference, the lift will reopen, or re-shut the door until sundries are eliminated.
	Up/down over-run and final limit protection	The device can effectively prevent from the lift's surging to the top or knocking the bottom when it is out of the control. It results in the more safe and reliable lift travel.
	Down over-speed protection device	When the elevator down 1.2 times higher than the rated speed, this device will automatically cut off control power, stop the motor running so as to stop lift down at over-speed. If the lift continues to down at over-speed, and the speed is 1.4 times higher than rated speed, safety tongs act to force the lift stop in order to ensure the safety.
	Upward over-speed protection device	When the lift ups 1.2 times higher than rated speed, the device will automatically decelerate to brake the lift.
	Micro-touch button for car call and hall call	Novel micro-touch button is used for operation panel command button in the car and landing calling button.
	Floor and direction indicator car	The car shows the lift floor location and current travel direction.
	Floor and direction indicator	The landing panel shows the lift floor location and current travel direction.

 Emergency Function	Emergency car lighting	Emergency car lighting automatically activated when there is power failure.
	Inching running	When the elevator enters into emergency electric operation, the car travels at low speed inching running.
	Five way intercom	Communication amid car, car top, elevator machine room, well pit and rescue duty room through walkie-talkie.
	Bell	In emergency conditions, if bell button above car operation panel is continuously pressed, electric bell rings on top of the car.
 Energy-saving Function	Fire emergency return	If you start key switch in main landing or monitor screen, all the callings will be cancelled. The elevator directly and immediately drives to the designated rescue landing and automatically opens the door.
	Car ventilation, light automatic shut off	If there is no calling or command signal within the stipulated time, the car fan and lighting will be automatically closed in order to save the energy.
	Remote shut-off	The elevator can be called to main landing (after finishing the service) through the key switch and automatically exists the service.

★ Optional Function

 Emergency Function	Leveling when power failure	In normal power failure, the chargeable battery supplies the elevator to power. The elevator drives to the nearest landing.
	Anti-nuisance	In the light elevator load, when three more commands appear, in order to avoid the unnecessary parking, all the registered callings in the car will be cancelled.
	Open the door in advance	When the elevator decelerates and enters into door open zone, it automatically opens the door to enhance the travel efficiency.
	Direct parking	It completely accords with distance principle with no crawling in the leveling. It greatly enhances the travel efficiency.
 Travel Function	Group control function	When three or more same model lift groups are controlled in use, the lift group can automatically choose the most appropriate response. It avoids the repeated lift parking, reduces the passengers' waiting time and increases the travel efficiency.
	Duplex control	Two sets of same model elevators can unanimously respond the calling signal through the computer dispatch. In this way, it reduces the passengers' waiting time to the greatest extent and enhances the travel efficiency as well.
	On-duty peak service	Within the preset on-duty time, upward transport from the home landing is extremely busy. The lifts are continuously dispatched to the home landing in order to satisfy on-duty peak service.
	Off-duty peak service	Within the preset off-duty period, the lifts are continuously dispatched to top floor in order to satisfy off-duty peak service.
 Man-machine Interface	Door open time extending	Press special button in the car, the lift door keeps open for certain period of time.
	Car arrival gong	Arrival long in the car top announces that the passengers arrive.
	Voice announcer	When the elevator normally arrives, voice announcer informs the passengers about the relevant information.
	Car assistant operation box	It is used in the large loading weight lifts or the elevators with crowded passengers so that more and more passengers can use the car.
 Monitor Function	Operation box for the handicapped	It is convenient for the wheelchair passengers and those who have vision problems.
	Intelligent calling service	The car command or hoist-way calling can be locked or connected through special Intelligent Input.
	IC card control function	All (partial) landings can only input car commands through IC card after authorization.
	Remote monitor	The elevator long-distance monitor and control can be fulfilled through modem and telephone. It is convenient for the factories and service units to timely know the travel conditions of every elevator and promptly take the corresponding measures.
	Remote control	The lift car have independent travel according to the specific requirements through operation monitor screen (optional).
	Camera function in the car	The camera is installed in the car to monitor the car conditions.

STANDARD CONFIGURATION



FJJ-CD-106 Standard

Stainless steel car

Ceiling: FJJ-CC-509 style, arched top-plate, bright lighting

Car wall: Hairline stainless steel

Operation panel: FJJ-COP-010

Car door: Hairline stainless steel, center opening

Floor: FJJ-CF-601

Operation panel



FJJ-COP-010

Landing door



FJJ-DP-321



FJJ-DP-318



FJJ-DP-395

Ceiling



FJJ-CC-509
Arched top-plate, bright lighting



FJJ-CC-537
Central LED luminous panel,
LED down lamps on both sides

Outbound call



FJJ-LOP-010

Floor



FJJ-CF-601



FJJ-CF-603



FJJ-CF-604



FJJ-LOP-010B

PASSENGER ELEVATOR CAR DECORATION

-ECONOMIC SERIES



FJJ-CD-108 Economic Solution

Ceiling: St.St frame with milk white acrylic lighting deco two sides.
Middle Panel: Mirror, Etching.
Side Panel: Hairline.
Handrail model: FJJ-CH-701



FJJ-CD-115

Ceiling: St.St frame with white acrylic lighting panel.
Middle Panel: Mirror.
Side Panel: Mirror, Etching.
Handrail model: FJJ-CH-711

FJJ-CD-107

Ceiling: St.St frame with multi-layer lighting board, acrylic lighting deco.
Middle Panel: Mirror, Etching.
Side Panel: Hairline.
Handrail model: FJJ-CH-701



FJJ-CD-116

Ceiling: St.St frame with white acrylic lighting panel.
Middle Panel: Mirror, Etching.
Side Panel: Hairline.
Handrail model: FJJ-CH-701



FJJ-CD-129



FJJ-CD-131



FJJ-CD-142



FJJ-CD-146



FJJ-CD-150



FJJ-CD-155



FJJ-CD-164



FJJ-CD-168



FJJ-CD-303

PASSENGER ELEVATOR CAR DECORATION

-MODERN SERIES



FJJ-CD-113 Modern Solution

Ceiling: St.St frame with white acrylic lighting panel.
Middle Panel: Mirror, Hairline, Etching.
Side Panel: Mirror.



FJJ-CD-109

Ceiling: St.St frame with green white acrylic lighting panel.
Middle Panel: Mirror, Etching, Hairline, Concave Green.
Side Panel: Mirror, Etching, Hairline, Concave Green.



FJJ-CD-110

Ceiling: St.St frame with white acrylic lighting panel.
Middle Panel: Mirror, Etching.
Side Panel: Pasted Wooden Deco.
Handrail model: FJJ-CH-709



FJJ-CD-112

Ceiling: St.St frame with white painted acrylic lighting panel.
Middle Panel: Mirror, Etching.
Side Panel: Mirror.



FJJ-CD-153



FJJ-CD-429



FJJ-CD-432



FJJ-CD-433



FJJ-CD-434



FJJ-CD-435



FJJ-CD-436



FJJ-CD-K106



FJJ-CD-K107

PASSENGER ELEVATOR CAR DECORATION

-LUXURY SERIES



FJJ-CD-407 Luxury Solution

Condole top: Mirror stainless steel border, medium is white organic transparent board

Center plate: leather soft bag

Auxiliary plate: mirror, etch, stainless steel

Handrail: organic glass armrest

Floor: 2mmPVC spline.(optional marble)



FJJ-CD-409

Condole top: four sides wooden adornment frame, middle mirror titanium, concealed light, LED illum.

Center board: leather soft bag, wood decoration

Auxiliary board: Center of the mirror titanium, surrounding wood decorative frame

Handrail: titanium garden handrail

FJJ-CD-400

Ceiling: titanium mirror stainless steel, common roof, lamp lighting

Center plate: mirror, and grain, titanium

Auxiliary board: mirror, and grain, titanium

Handrail: wood and titanium combination round tube handrail

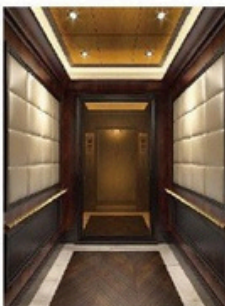

FJJ-CD-410

Condole top: wooden condole top border, tube lamp illum

Back wall: Wood veneer, advertising frame, mirror stainless steel (self-care of advertising drawing customers)

Side wall: wood decoration, cloth art

Handrail: stainless steel leather armrest



FJJ-CD-411



FJJ-CD-413



FJJ-CD-414

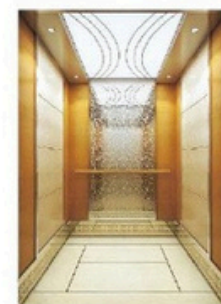

FJJ-CD-415

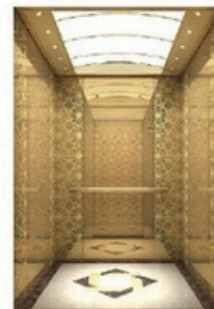

FJJ-CD-419



FJJ-CD-421

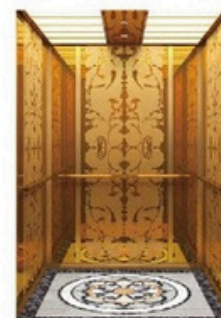

FJJ-CD-422



FJJ-CD-441



FJJ-CD-442

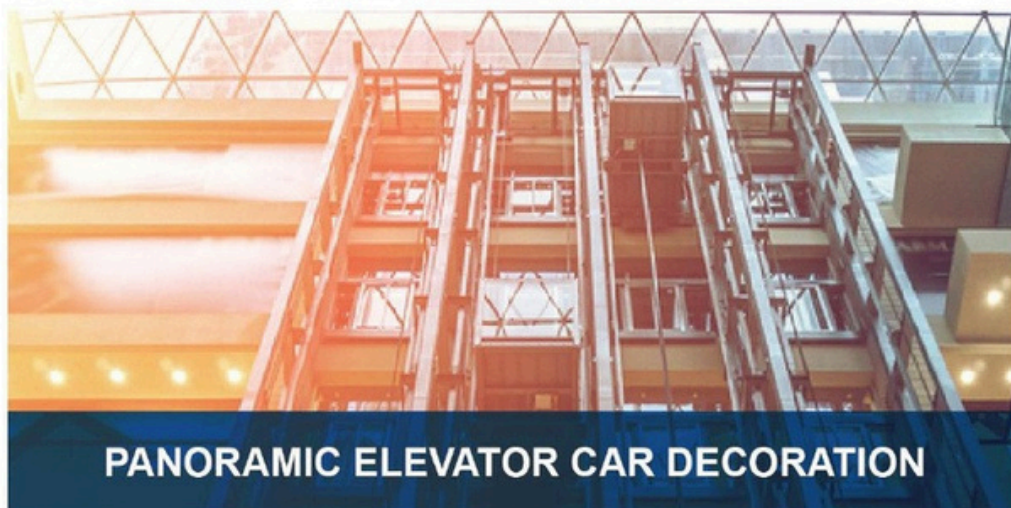

FJJ-CD-912 Economic Solution

Upper and lower cover: Steel plate spraying
 Sightseeing wall: Safety clip glass
 Decorative top: HM-427 ceiling
 Cage wall: Safety clip glass
 Handrail: Stainless steel plate
 Floor: PVC floor



ECONOMIC SERIES



FJJ-CD-902

Upper&Bottom Canopy: Hairline
 Viewing Glass: Laminated
 Glass(2LAYERS)
 Cabin Wall: Hairline ST/ST
 Handrail: ST/ST Tube
 Floor: PVC



FJJ-CD-910

Upper & Bottom Canopy: Hairline
 with Light Deco
 Viewing Glass: Laminated Glass(2
 Layers)
 Cabin Wall: Hairline ST/ST
 Handrail: ST/ST Tube
 Floor: PVC

FJJ-CD-901

Upper&Bottom Canopy: Hairline
 Viewing Glass: Laminated
 Glass(2Layers)
 Cabin Wall: Hairline ST/ST
 Handrail: ST/ST Tube
 Floor: PVC



FJJ-CD-313

Upper and lower cover: Steel plate
 spraying with acrylic decorative strip
 Sightseeing wall: Three pieces of
 safety glue glass
 Decorative top: Image board and the
 lantern on both sides
 Cage wall: Stainless steel plate
 Handrail: Stainless steel double pipe
 Floor: PVC floor



FJJ-CD-314

Upper and lower cover: Steel plate
 spraying
 Sightseeing wall: Three pieces of
 safety glue glass
 Decorative top: Image board and the
 lantern on both sides
 Cage wall: Stainless steel plate
 Handrail: Stainless steel double pipe
 Floor: PVC floor

FJJ-CD-966

Upper & Bottom Canopy: Baked
 Enamel
 Viewing Glass: Laminated
 Glass(3Pcs)
 Cabin Wall: Hairline Etching
 Etching ST/ST
 Handrail: ST/ST Tube
 Floor: PVC



PANORAMIC ELEVATOR CAR DECORATION

FJJ-CD-940 Modern Solution

Center plate: Mirror, stone relief,
titanium

Auxiliary board: Wood grain relief



MODERN SERIES



≈ FJJ-CD-934

Center plate: Hairline , etching



≈ FJJ-CD-945

Upper & Bottom Canopy: Steel
paint,Lighting
Viewing Glass: Sandwiched glass
Decorative top:Steel paint,Acrylic
roof,Lighting
Cabin Wall: Stainless steel process tube
Handrail: Stainless steel tube
Floor: PVC

≈ FJJ-CD-941

Upper & Bottom Canopy: Baked
Enamel
Viewing Glass: Laminated
Glass(3Pcs)
Cabin Wall: Hairline Etching St./St
Handrail: St./St. Tube
Floor: PVC



≈ FJJ-CD-980

Upper and lower cover: Ladder
pentagon steel paint and decorative
lights
Sightseeing wall: Safety laminated glass
Decorative top: Middle round acrylic top
lamp,Simple lights on both sides
Cage wall: Stainless steel hair plate
Handrail: Single stainless steel tube
Floor: PVC floor



≈ FJJ-CD-933

Upper & Bottom Canopy:
Semicircular Acrylic Crown with
Metal Cover and Steel Plate
Spraying Coaming
Viewing Glass: Laminated
Glass(3Pcs)
Cabin Wall: Stainless steel hairline
Handrail: Stainless steel double
tube
Floor: PVC



≈ FJJ-CD-981

Upper and lower cover: Steel plate
spraying
Sightseeing wall: Three pieces of
safety glue glass
Decorative top: Multi-layer reflective
process board plus simple light
Cage wall: Stainless steel hairline
Handrail: Stainless steel single tube
Floor: PVC floor



PANORAMIC ELEVATOR CAR DECORATION



FJJ-CD-961 *Luxury Solution*

Upper&Bottom Canopy: Baked Enamel with Light Deco
Viewing Glass: Laminated Glass(3Pcs)
Cabin Wall: Golden Mirror Etching SL/St
Handrail: St/St. Tube
Floor: PVC

LUXURY SERIES



≈ FJJ-CD-962

Upper&Bottom Canopy: Half Round Baked Enamel with Acrylic Cop. light Deco
Viewing Glass: Laminated Glass(3Pcs)
Cabin Wall: MIRROR Etching SL/St
Handrail: St/St. Tube
Floor: PVC

≈ FJJ-CD-963

Upper&Bottom Canopy: Hairline Round
Viewing Glass: Laminated Glass(3Pcs)
Cabin Wall: Mirror Etching SL/St
Handrail: St/St. Tube
Floor: PVC



≈ FJJ-CD-964

Upper&Bottom Canopy: Baked Enamel with Light Deco
Viewing Glass: Laminated Glass(3Pcs)
Cabin Wall: Golden Mirror Etching SL/St
Handrail: St/St. Tube
Floor: PVC



≈ FJJ-CD-978

Upper and lower cover: Semicircle acrylic crown and stainless steel coaming
Sightseeing wall: Three pieces of safety glue
Decorative top: Multi-layer reflective process board with tube lamp
Cage wall: Mirror, hair, etching, and grain
Floor: PVC floor



≈ FJJ-CD-976

Upper and lower cover: Terraced round plate baking paint with decorative lights
Sightseeing wall: Three pieces of safety glue glass
Cage wall: Stainless steel titanium plate
Handrail: Stainless steel single pipe
Floor: PVC floor



≈ FJJ-CD-974

Upper and lower cover: Organic plate with metal strip and five deformation stool plate
Sightseeing wall: Safety clip glass
Decorative top: Image board with tube lamp
Cage wall: Mirror, hair line, etching, concave gold
Handrail: Stainless steel double pipe
Floor: PVC floor

OPERATION PANEL

► Operation panel series



FJJ-COP-012 Standard Solution



FJJ-COP-080 Economic Solution

FJJ-COP-020 Modern Solution

FJJ-COP-102 Luxury Solution

ELEVATOR CEILING SERIES



FJJ-CC-501

White arch light-emitting panel, stainless steel mirror frame, strip light decoration



FJJ-CC-502

Titanium gold stainless steel mirror base plate is supplemented with rectangle hollow transparent light pole, central soft lighting design of white organic panel



FJJ-CC-503

Stainless steel mirror hollow panel, white organic panel, mirror stainless steel frame



FJJ-CC-519

Round art panel model, rear soft lighting design of down lamp



FJJ-CC-520

Round steel bar model, white organic panel, rear soft lighting design of down lamp



FJJ-CC-521

Round hollow art panel model, rear soft lighting design of down lamp



FJJ-CC-504

Stainless steel titanium gold mirror hollow panel, white light-emitting panel, mirror stainless steel frame



FJJ-CC-505

Stainless steel mirror hollow panel, white organic panel, mirror stainless steel frame



FJJ-CC-506

Stainless steel mirror hollow panel, white organic panel, aluminum alloy frame



FJJ-CC-522

Round glass model, rear soft lighting design of down lamp



FJJ-CC-523

Round lotus pattern art panel, rear soft lighting design of down lamp



FJJ-CC-524

Central white ceiling lamp, four-side stainless steel base plate with soft lighting design of down lamp



FJJ-CC-507

Stainless steel mirror hollow panel, white organic panel, aluminum alloy frame



FJJ-CC-508

Mirror stainless steel panel is supplemented with rectangle hollow transparent light pole, central soft lighting design of white organic light-emitting panel



FJJ-CC-510

Central image arch, two-side stainless steel base plate is supplemented with soft lighting design of down lamp (image to be provided by client)



FJJ-CC-527

Stainless steel frame, white acrylic light-emitting

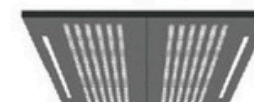

FJJ-CC-528

Stainless steel square tube frame, mirror stainless steel, down light



FJJ-CC-529

Stainless steel side frame + soft lighting design of arch white light-emitting panel



FJJ-CC-511

Soft lighting design of broad arch white light-emitting panel

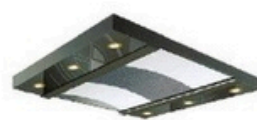

FJJ-CC-515

Central image arch, two-side stainless steel base plate, soft lighting design of down lamp



FJJ-CC-518

Soft lighting design of broad image arch



FJJ-CC-530

Stainless steel side frame + soft lighting design of arch white light-emitting panel



FJJ-CC-531

Stainless steel square tube frame, mirror stainless steel, down light



FJJ-CC-532

Stainless steel side frame + soft lighting design of arch white light-emitting panel

ELEVATOR PANEL SERIES



FJJ-DP-301 Standard Solution 
Mirror, Hairline, Etched



FJJ-DP-302 Standard Solution 
Mirror, Etched



FJJ-DP-334 Standard Solution 
Mirror, Etching, Concave Golden



FJJ-DP-343 Economic Solution 
Mirror, Etched, Hairline



FJJ-DP-347 Economic Solution 
Mirror, Etched, Hairline



FJJ-DP-348 Economic Solution 
Mirror, Etched

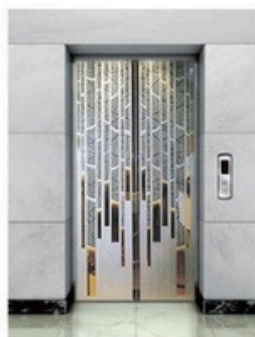

FJJ-DP-337 Standard Solution 
Mirror, Etching, Golden, Hairline



FJJ-DP-356 Standard Solution 
Mirror, Etching, Hairline



FJJ-DP-363 Standard Solution 
Mirror, Etching, Hairline, Concave Golden



FJJ-DP-323 Luxury Solution 
Mirror, Etched, Rose gold



FJJ-DP-336 Luxury Solution 
Mirror, Etched, Titanium Golden



FJJ-DP-339 Luxury Solution 
Mirror, Etched



FJJ-DP-427 Standard Solution 
Titanium, Mirror, Etching



FJJ-DP-321 Standard Solution 
Mirror, Hairline



FJJ-DP-322 Economic Solution 
Mirror, Etched



FJJ-DP-388 Luxury Solution 
Mirror, Etching, Titanium Golden

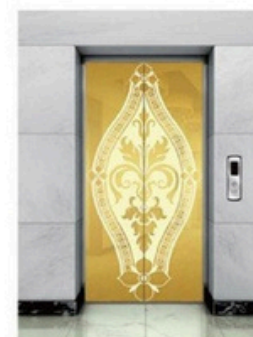

FJJ-DP-395 Luxury Solution 
Mirror, Etching, Titanium Golden



FJJ-DP-396 Luxury Solution 
Mirror, Hairline, Titanium Golden

ELEVATOR FLOOR SERIES

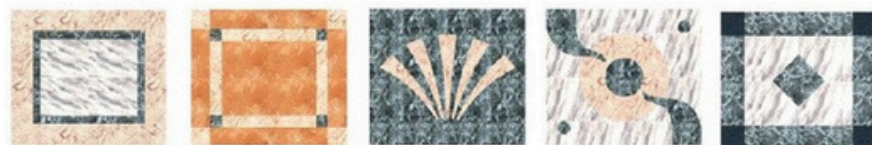

FJJ-CN-601

FJJ-CN-602

FJJ-CN-603

FJJ-CN-604

FJJ-CN-605

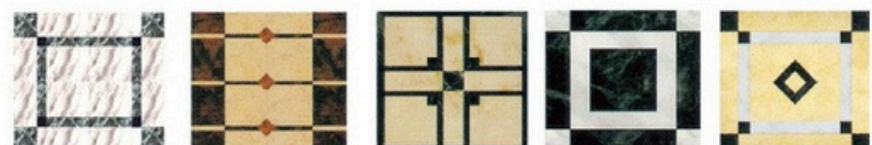

FJJ-CN-606

FJJ-CN-615

FJJ-CN-616

FJJ-CN-620

FJJ-CN-621



FJJ-CN-609

FJJ-CN-610

FJJ-CN-613

FJJ-CN-614

FJJ-CN-696

OPTIONAL COLORS



FJJ-SK001
PAL 7047

FJJ-SK002
PAL 7040

FJJ-SK003
PAL 1015

FJJ-SK004
PAL 7032

FJJ-SK005
PAL 5002

FJJ-SK006
PAL 5024

FJJ-SK007
PAL 6021

FJJ-SK008
PAL 3015

ELEVATOR HANDRAIL SERIES



FJJ-CH-701



FJJ-CH-703



FJJ-CH-711

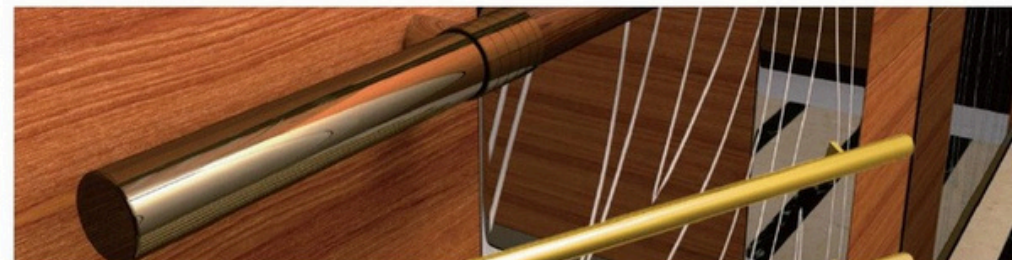

FJJ-CH-702



FJJ-CH-704



FJJ-CH-709



FJJ-CH-707

FREIGHT ELEVATOR



▼ A loading giant that can release more and more cargo pressures for you

FUJI JAPAN freight lift serial fully utilizes the advanced and fully computerized control technology. It employs the well-developed VVVF control system of FUJI JAPAN elevator. It is simple in structure and convenient in repair and maintenance. It fulfills a qualitative leap in the aspects of the signal transmission and running control. It brings about the more stable and reliable system, the lower noise, the smoother running, the more accurate leveling. It is more and more easy for the goods entry and exit. In addition, FUJI JAPAN freight lift serial can offer the micro-processor. The high speed running capabilities and expansion interface ensure to satisfy the special requirements from broad users.



▼ Light curtain protection

Several protective light curtains are formed at the entrance of the elevator, which sensibly detects and responds to any objects that intrude into the detecting scope. The safety of human and cargoes are guaranteed.

▼ The extremely humane operation

It is equipped with fully automatic collective selective function. It can fulfill operation with driver / without driver. The operation box specially and additionally sets "door-shut delay" button in the operation box. Door-shut delay time can be flexibly adjusted at site according to the requirements. You feel more at ease at loading and unloading the goods out of its humane setting.

Freight Elevator Construction Sketch

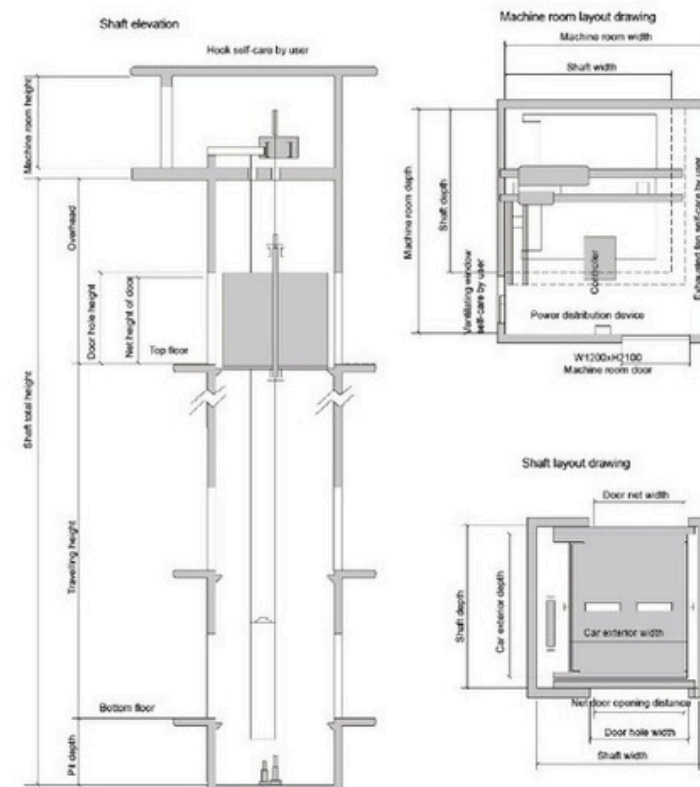

Freight elevator parameter table

Load (kg)	Speed (m/s)	Net size of car(mm)	Net size of door(mm)	Shaft net size(mm)			Machine room net size(mm)		Door open type
		C.Wx DxD H	D WxD H	width x depth	Overhead height	Pit depth	width x depth	height	
630	0.5	1200*1500*2200	1100*2100	2100*1980	4200	1500	2500*3000	2200	Two panel side opening
1000	0.5	1500*1800*2200	1200*2100	2250*2160	4200	1500	3000*3000	2200	Two panel side opening
2000	0.5	1570*2900*2200	1500*2100	2700*3260	4200	1500	3500*3000	2500	Two panel side opening
	1.0			4500	1500				
	1.5	2000*2300*2200		2650*2860	4500	1800			Four panel center opening
	2.0				4800	1800			
3000	0.25 0.5	2070*3050*2200	1600*2100	3300*3410	4500	1500	3800*4200	2500	Four panel center opening
3200	1.0	2070*3100*2200	1800*2100	3300*3460	4500	1500	3800*4200	2500	Four panel center opening
5000	0.25 0.5	2800*3400*2500	2000*2200	4200*3300	5000	1800	4200*3800	2800	Four panel center opening
7000	0.25 0.5	3000*4200*2500	2600*2400	4500*4600	5000	1800	4500*4600	2800	Four panel center opening
10000	0.25	3070*5760*2500	2600*2400	4900*6200	5000	1800	4900*6200	2800	Four panel center opening

Note: Reference only, for detail information, please contact FUJI JAPAN elevator.

CAR ELEVATOR



Perfect Space for Cars

We develop and produce FUJI JAPAN automobile elevator through absorption, transformation and enhancement by introducing the world's, well-developed automobile elevation technology. The powerful technical capacity of FUJI JAPAN reduces the traction system burden due to uneven force to the elevator car. It solves the technical obstacle of shaking elevator car due to noise production. It optimizes the characteristics of the product series.



⚡ Dual operation panels design(Optional)

There are two operation box in the car. Therefore the driver can operate the elevator in the car without stepping out of it.



⚡ Special-purpose circuit control and display system

Special circuit control and display system is convenient for the drivers inside/outside the car.



⚡ Front-and-rear opening elevator car

The elevator car sets front/rear door opening which is more convenient for the safety sector and for the cars to enter into/exit from the elevator cars.

Car Elevator Construction Sketch

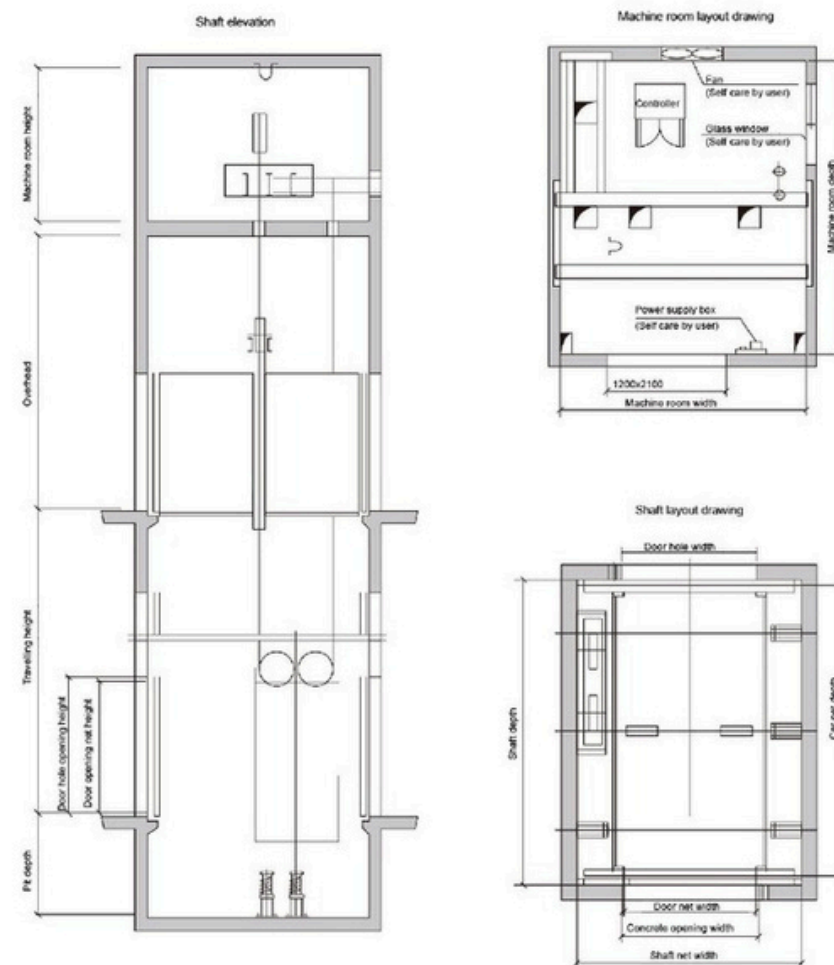

Car elevator parameter table

Load (kg)	Speed (m/s)	Door open type	Net door opening widthxheight(mm)	Exterior size of car widthxdepth(mm)	Shaft net size(mm)		Machine room net size(mm)
					widthxdepth	pit depth	widthxdepthxheight
3000	0.25/0.5	Four Panel Center Opening	2400*2200	2700*5800	4100*6160	1600	4100*6160*2500
5000	0.25/0.5	Four Panel Center Opening	2600*2200	3500*7200	4750*7560		4750*7560*2500

Note:Reference only, for detail information,please contact FUJI JAPAN elevator.

FREIGHT ELEVATOR CAR DECORATION

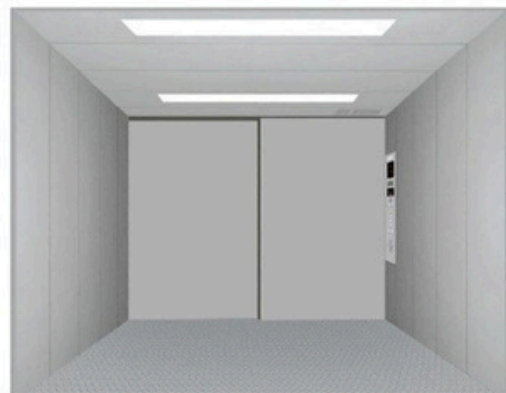

Side Opening

FJJ-CD-F100 (Standard)

Item	Specification
Car ceiling	Painted panel,energy-saving light
Ventilation	Square fan
Car wall	Painted panel(Standard) Hairline stainless steel(Optional)
Car door	Painted panel(Standard) Hairline stainless steel(Optional)
Floor	Checked stainless steel plate
Sill	Steel sill(Open width > 1500) Reinforced aluminum alloy(Open width ≤ 1500)

FJJ-CD-F200 (Standard)

Item	Specification
Car ceiling	Painted panel,energy-saving light
Ventilation	Round fan
Car wall	Painted panel(Standard) Hairline stainless steel(Optional)
Car door	Painted panel(Standard) Hairline stainless steel(Optional)
Floor	Checked stainless steel plate
Sill	Steel sill(Open width > 1500) Reinforced aluminum alloy(Open width ≤ 1500)



Double-folded Center Opening Type

OPERATION PANEL



FJJ-COP-160

Operation panel: Hairline stainless steel

FLOOR



Ordinary checked
steel plate I
(Standard)

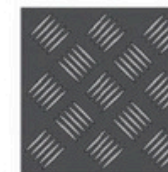

Ordinary checked
steel plate II
(Optional)

CRASH BARRIER



Wooden



Rubber

LANDING DOOR



Center opening



Side opening



Double-folded
center opening type



3-Folded
center opening type

POWDER COATING COLOR(OPTIONAL)



ice gray
FJJ-SK001



plane gray
FJJ-SK002



corn yellow
FJJ-SK003



light green
FJJ-SK007

ESCALATOR



Perfect Model Brings About The Better Riding Experience

Extremely long life, energy efficient delivery, stable and reliable performance, will be on your right-hand man, is the best carrying tools. FUJI JAPAN escalator to the excellent performance, practical and flexible design to meet different customer needs. Priority use of microcomputer variable frequency(VVVF) and ergonomics research and advanced manufacturing technology, FUJI JAPAN escalator is more perfect, safe, comfortable, energy-saving, easy maintenance.

Optimized Design Saves The Space

Minimum span size greatly saves the occupied space. The compact pit depth design brings about a freer construction layout.

City Large-flow Traffic Solution Plan Specialist

It innovatively combines with human-centered ideas. It has the advanced stairway and belt design. It is smooth and comfortable in operation. Solemn and smooth handrail entry, traffic flow light appear bright and dynamic. It perfectly connects with inner/outer cover plates, skirting plate, frontline plate. It smoothly transits to big arc rotary end handrail.

FUJI JAPAN escalators are widely applicable for the airport, railway station, high grade hotel, CBD, large-size shopping center, public facilities etc. It adds a brilliant sight line for modern building.

- Its truss adapt the superior profile steel with unique structure, high intensity, through anti-rusting, good effect, long life.
- The advanced international manufacture craft, technology, general assembly, tooling guarantee the precise elevator path.
- Super-strong CPU master-board computer control executes real-time monitor to the running conditions. It automatically stops at any abnormal conditions. It also promptly and automatically makes records, displays the trouble code.

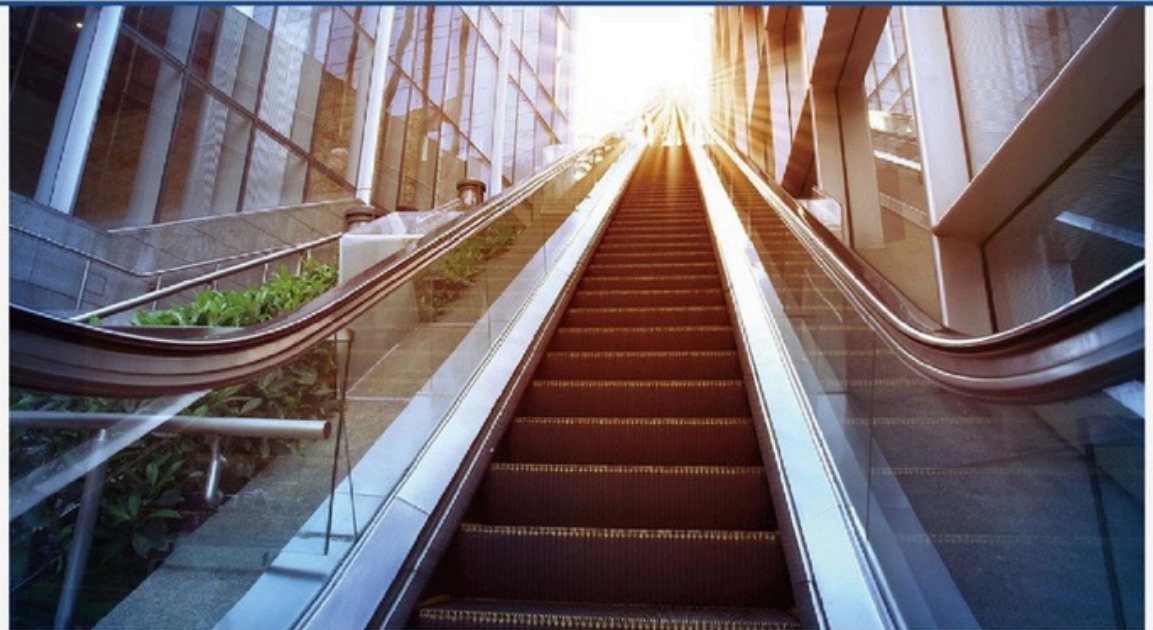

30° ESCALATOR CONSTRUCTION SKETCH

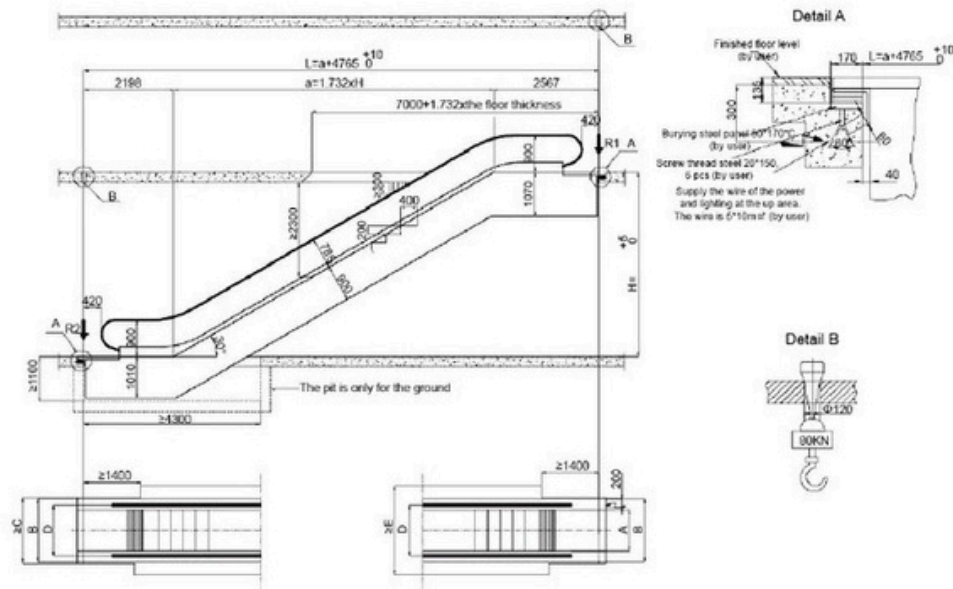

Reacting force

Step width	600	800	1000	Remark
R1(KN)	3.5xL+15.5	4xL+17	4.5xL+18.5	L=mm
R2(KN)	3.5xL+90	4xL+11	4.5xL+11.5	

Power motor(step width 1000mm speed 0.5m/s)

5.5KW	8KW	11KW
1.5m<H≤3.2m	3.2m<H≤4.8m	4.8m<H≤6.0m

Table of rules of extension interior escalator's upper part

	Power			
	Step width <1500	1500	2X1100	2X1500
Without VVVF	600	417	417	
	800	0	0	500
	1000	0	0	500 800
With VVVF	600	417	417	
	800	0	200	500
	1000	0	0	500 800

Standard specification and dimension

Model	600	800	1000
Step width	A	600	800 1000
Decorating width	B	1140	1340 1540
Construction open width	C	1200	1400 1600
Splice between handrail	D	838	1038 1238
Construction open width	E	1778	1978 2178

Notes		Specification parameter
*The layout drawing is suitable for the construction which the height is below 6m. *If the step width is 600mm, 417mm shall be extended at the up of the truss.	Type	FJJ-ES-600-30 FJJ-ES-800-30 FJJ-ES-1000-30
	Speed	0.5m/s
	Rise height	1156000mm
	Angle	30°
	Supporting R1	KN
	Supporting R2	KN
	Weight W	KN
	Power supply	Three-phase AC 380V 50HZ Single-phase AC 220V 50HZ

35° ESCALATOR CONSTRUCTION SKETCH

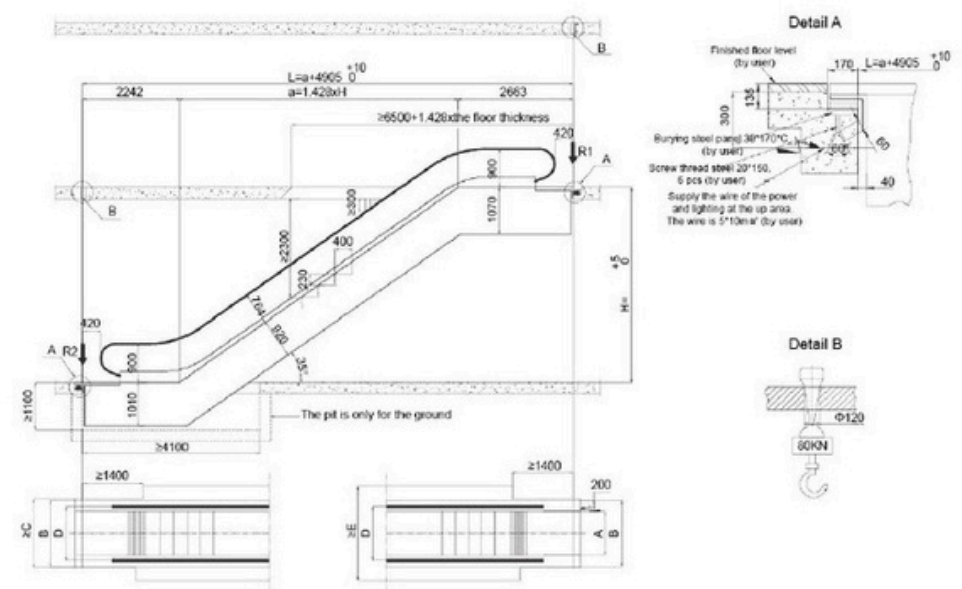

Reacting force

Step width	600	800	1000	Remark
R1(KN)	3.5xL+15.5	4xL+17	4.5xL+18.5	L=mm
R2(KN)	3.5xL+10	4xL+11	4.5xL+11.5	

Power motor(step width 1000mm speed 0.5m/s)

5.5KW	8KW	11KW
1.5m<H≤3.5m	3.5m<H≤5.0m	5.0m<H≤6.0m

Table of rules of extension interior escalator's upper part

	Power			
	Step width <1500	1500	2X1100	2X1500
Without VVVF	600	417	417	
	800	0	0	500
	1000	0	0	500 800
With VVVF	600	417	417	
	800	0	200	500
	1000	0	0	500 800

Standard specification and dimension

Model	600	800	1000
Step width	A	600	800 1000
Decorating width	B	1140	1340 1540
Construction open width	C	1200	1400 1600
Splice between handrail	D	838	1038 1238
Construction open width	E	1778	1978 2178

Notes		Specification parameter
*The layout drawing is suitable for the construction which the height is below 6m. *If the step width is 600mm, 417mm shall be extended at the up of the truss.	Type	FJJ-ES-600-35 FJJ-ES-800-35 FJJ-ES-1000-35
	Speed	0.5m/s
	Rise height	1156000mm
	Angle	35°
	Supporting R1	KN
	Supporting R2	KN
	Weight W	KN
	Power supply	Three-phase AC 380V 50HZ Single-phase AC 220V 50HZ

MOVING WALK



Extremely strong conveying capacities

- Moving walk has extremely strong conveying capacity. It can satisfy the traffic requirements of modern people in various aspects. It is applicable for the airport, shopping center, hotel, recreation center etc.
- Its unique and innovative design has minimum requirements to the space. Its firm structure is strong enough for any kind of load. At the same time of conveying large-size shopping plaza and busy airport, bus station, it saves every piece of precious space. It fully considers the requirements of modern city traffic.
- 0-12° angle of inclination can be freely choice according to different use and environment in the building.

Perfect Experience, Whole Hearted Contribution of FUJI JAPAN Elevator

FUJI JAPAN moving walk suits the occasions of large passenger flow, long operation time, long-distance delivery of passengers, luggage and goods. It follows the world's high tech development trend. It applies the advanced manufacture craft & technology. It goes all out to put out FUJI JAPAN moving walk, 0-12° multiple styles are available for the users' free choices. FUJI JAPAN moving walks are widely applicable for available big shopping malls, aviation ports, super-markets, recreation centers etc. It solves big carring problems of large passenger flows. It satisfies long-distance walk, carrying of luggage cart, baby's cart; shopping cart, wheel chair for the disabled and so on. It is as easily as walking on firm earth. It is greatly convenient for people's outing and shopping.

FUJI JAPAN moving walk on behalf of the new trend of industry-leading manufacturing, innovative, stylish, streamlined design and creative styling, make the product look gorgeous and dignified, dignity and style of the highlights with the support of the building, moving walk and architecture harmony between, seamless, complement to each other.

FUJI JAPAN moving walk shape luxurious, very stylish aesthetic, harmonious intogration and the metropolis modern architecture and interior, the perfect interpretation of new state of the art technology, safe and reliable, energy saving, smooth and comfortable design concept.



12° MOVING WALK CONSTRUCTION SKETCH

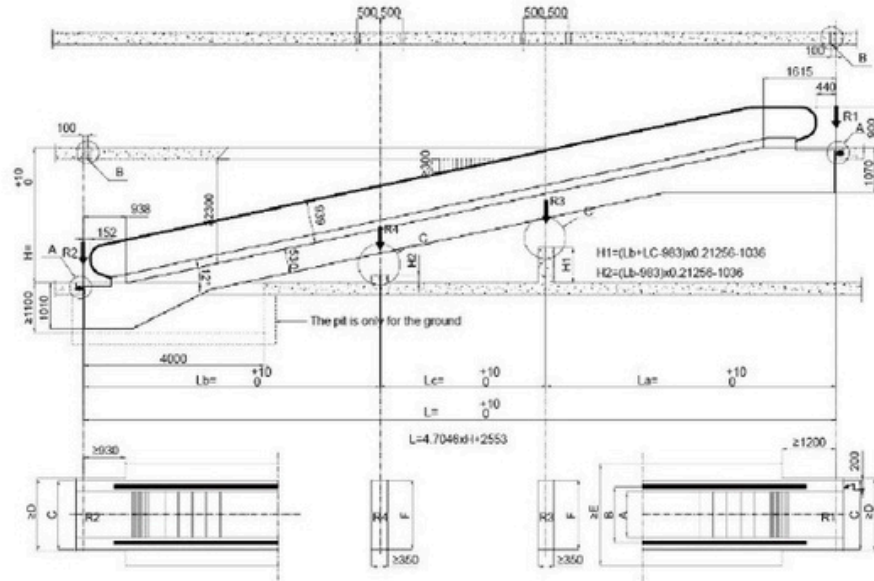

Detail A

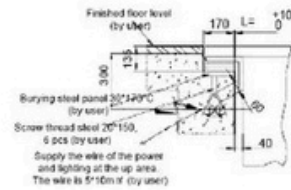

Detail B



Detail C

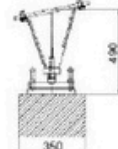

Power motor (Pedal width 1000mm speed 0.5m/s)

5.5KW	8KW	11KW
1.2m x 0.3m	3.0m x 0.4m	4.5m x 0.5m
15KW		
6.0m x 0.7m		

Step width	q	M	N	D	1400	1600
800	0.0039	9.5	4.5	E	2050	2250
1000	0.0045	11	5	F	1340	1540
Angle	Rise height	Middle support	La	Lb	Lc	
12°	From To	R3 R4	-	-	-	-
	1601 2653	-	-	-	-	-
	2654 5851	1	-	L/2	L/2	-
	5852 8000	1	1	L/3	L/3	L/3

Table of rules of extension interior moving walk's upper part

	Power			Supporting		
	Step width	15KW	15KW	2X11KW	2X15KW	
Without VVVF	800	0	0	500	800	
With VVVF	800	0	200	500	800	
	1000	0	0	500	800	
	1000	0	0	500	800	

Notes	Type	Specification parameter
* The layout drawing is suitable for the construction which the height is below 7m.	FJJ-ES-800-12	
	FJJ-ES-1000-12	
	Speed	0.5m/s
	Rise height	1167000mm
	Angle	12°
	Supporting R1	KN
	Supporting R2	KN
	Weight W	KN
	Power supply	Three-phase AC 380V 50Hz
	Lighting supply	Single-phase AC 220V 50Hz

0° MOVING WALK CONSTRUCTION SKETCH

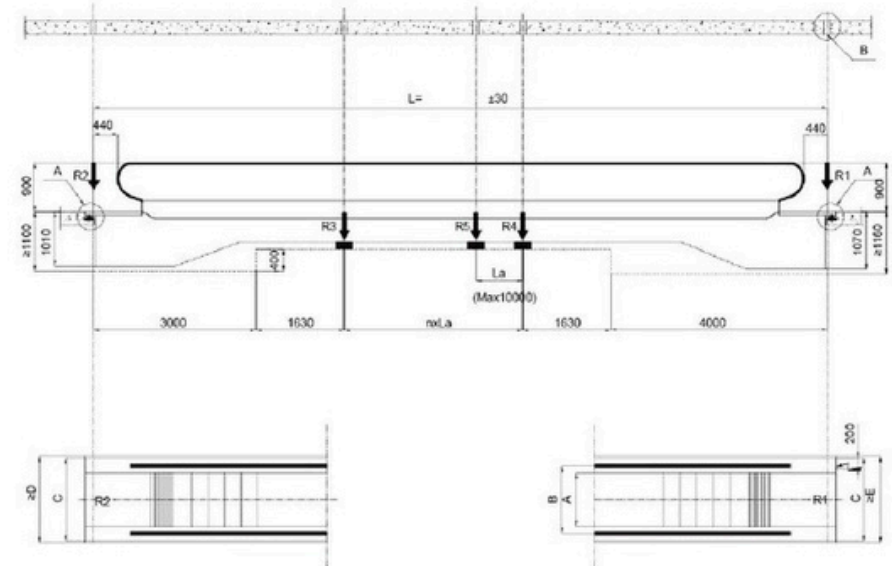

Detail A

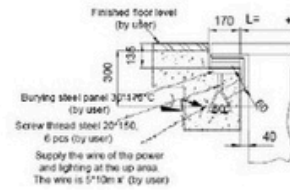

Detail B

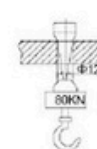

Power motor (Pedal width 1000mm speed 0.5m/s)

5.5KW	8KW	11KW
1.2m x 0.3m	3.0m x 0.4m	4.5m x 0.5m
15KW		
6.0m x 0.7m		

Table of rules of extension interior moving walk's upper part

	Power			Supporting		
	Step width	15KW	15KW	2X11KW	2X15KW	
Without VVVF	800	0	0	500	800	
With VVVF	800	0	200	500	800	
	1000	0	0	500	800	
	1000	0	0	500	800	

Notes	Type	Specification parameter
* This drawing is applicable to the civil construction of moving walkways.	FJJ-ES-800-0	
	FJJ-ES-1000-0	
	Speed	0.5m/s
	Horizontal span	L≤10000mm
	Angle	0°
	Supporting R1	KN
	Supporting R2	KN
	Weight W	KN
	Power supply	Three-phase AC 380V 50Hz
	Lighting supply	Single-phase AC 220V 50Hz